



ROBERT H. PETERSON CO.

Real Fyre®
Hand-Crafted Gas Logs Since 1949

**OWNER'S
MANUAL**

Burner Systems:

G10-24/30(P)
G10-24/30-12(M)(P)
G10-24/30-15(M)(P)
G10-24/30-01V(P)

Log Sets:

Charred Trail Oak
CHT-24 and 30
Charred Aged Split Oak
CHAS-24 and 30
Charred Summit Oak
CHSM-24 and 30
Charred Frontier Oak
CHFR-24 and 30

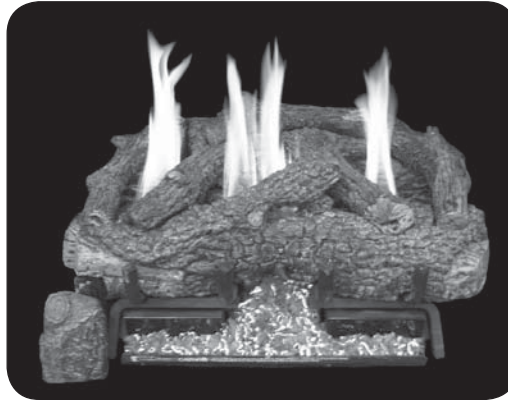

DESIGN CERTIFIED
to
Unvented Room Heater Standard
ANSI Z21.11.2-2007
and
Vented Decorative Appliance
ANSI Z21.60b-2004

G10 SERIES UNVENTED GAS LOG SETS FOR NATURAL OR PROPANE GAS

⚠ WARNING

If the information in this manual is not followed exactly, a fire or explosion may result, causing property damage, personal injury, or loss of life.

Do not store or use gasoline or other flammable vapors and liquids in the vicinity of this or any other appliance.

WHAT TO DO IF YOU SMELL GAS:

- Open a window.
- Do not try to light any appliance.
- Do not touch any electrical switch; do not use any phone in the building.
- Immediately call the gas supplier from a neighbor's phone. Follow the gas supplier's instructions.
- If you cannot reach the gas supplier, call the fire department.
- Installation and service must be performed by a qualified professional installer, service agency, or the gas supplier.

This appliance is only for use with the type of gas indicated on the rating plate.

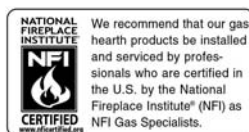

INSTALLER: Leave these instructions with consumer.
CONSUMER: Retain for future reference.

Important: Read these instructions carefully before starting installation of the log set.

This appliance may be installed in an aftermarket, permanently located, manufactured (mobile) home where not prohibited by local codes.

This appliance is only for use with the type of gas indicated on the rating plate. This appliance is not convertible for use with other gasses.

This is an unvented gas-fired heater. It uses air (oxygen) from the room in which it is installed. Provisions for adequate combustion and ventilation air *must* be provided. Refer to section entitled VENTILATION AND CONFINED SPACE INFORMATION.

This appliance is designed as an **attended appliance**. Adults must be present when the unit is operating. Do not leave this unit burning when unattended or while anyone is sleeping.

Installation, service, and the provisions for combustion and ventilation air **MUST** conform with local codes and with the *National Fuel Gas Code*, ANSI Z223.1/NFPA 54, or the CSA B149.1, *Natural Gas And Propane Installation Code*.

TABLE OF CONTENTS

TABLE OF CONTENTS	2
G10 SPECIFICATIONS AND REQUIREMENTS	3
PRE-INSTALLATION AND FIREPLACE PREPARATION SAFETY	4
IMPORTANT SAFETY INFORMATION	5
INSTALLATION SAFETY INFORMATION	6
INSTALLATION SAFETY GUIDELINES	6
OPERATIONAL SAFETY INFORMATION	7
VENTILATION AND CONFINED SPACE SAFETY INFORMATION	9
MINIMUM CLEARANCE TO COMBUSTIBLES	10
LOGS - PARTS LIST	11
BURNER PARTS LIST FOR MANUAL VALVE	12
BURNER PARTS LIST FOR SERIES 12 VALVE	13
BURNER PARTS FOR SERIES 15 VALVE	14
BURNER PARTS FOR SERIES 01V VALVE	15
WHEN USED AS A VENTED DECORATIVE APPLIANCE (PER ANSI Z21.60b-2004)	16
INSTALLATION - CONNECTING THE GAS TO THE BURNER SYSTEM	16
INSTALLATION	17
CONTROL SETTINGS	17
INSTALLATION: CHECKING GAS PRESSURE	18
CHECKING GAS PRESSURE	18
INSTALLATION: GRANULE, EMBER AND LOG PLACEMENT	19
LAVA GRANULE PLACEMENT	19
INSTALLATION: LOG PLACEMENT	20
FIBER LOG PLACEMENT	20
HARD CERAMIC (NON-FIBER) LOG PLACEMENT	20
INSTALLATION: LOG PLACEMENT (Cont.)	21
CLEANING AND SERVICING SAFETY INFORMATION	22
CLEANING AND SERVICING	22
CLEANING AND SERVICING	23
TO CLEAN THE LOG SET	23
CLEANING THE ODS PILOT	23
LOG SET NOTES PAGE	24
LIGHTING INSTRUCTIONS - SERIES 15 VALVE	25
LIGHTING INSTRUCTIONS - MANUAL VALVE	26
LIGHTING INSTRUCTIONS - SERIES 12 VALVE	27
LIGHTING INSTRUCTIONS - 01V(P) VALVE	28
TROUBLESHOOTING	29
FLAME DESCRIPTION	31
WARRANTY	32

G10 SPECIFICATIONS AND REQUIREMENTS

APPROVED INSTALLATIONS
Subject to minimum fireplace size requirements specified below:

1. Solid fuel burning fireplaces;
 - A) Prefabricated fireplaces listed to UL-127
 - B) All other masonry fireplaces
2. Universal listed vent-free fireplaces.

Note: Installation in any other fireplace is prohibited and will void any approvals and warranties.

Fig. 3-1

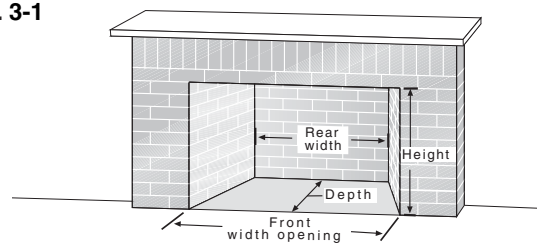

Fireplace dimensions

FIREPLACE SIZE REQUIREMENTS AND BTU RATING INFORMATION

The minimum size of FIREPLACE for installation of this G10 unvented gas log set is:				BTU rating			
Log set size	Width	Depth	Height	High setting		Low setting	
				Natural gas	Propane gas	Natural gas	Propane gas
24"	28" front 20" rear	14"	18"	37,000	37,000	19,000	19,000
30"	34" front 20" rear	14"	18"	37,000	37,000	19,000	19,000

The G10 Series vent-free gas log sets are available with a manual ODS pilot, an on-off remote, or a variable flame height control valve that can be used with the remote transmitter and receiver.

A spark ignition system (piezo) allows the gas ODS pilot to be lit without the use of matches, and permits the operation of the appliance during a power outage.

This vent-free gas log set is equipped with an Oxygen Depletion Sensor (ODS) safety pilot system. The ODS pilot senses the amount of oxygen available in the room and shuts the log set off before the oxygen level drops below 18%. The ODS pilot can only be relit when fresh air is available. **This may require opening a window or a door to another room, or cracking the damper open slightly.**

This gas log set has been certified to two standards:
UNVENTED ROOM HEATER-ANSI Z21.11.2-2007

VENTED DECORATIVE APPLIANCE-ANSI Z21.60b-2004

Check local or state codes to determine if vent-free heaters are permitted in your area before you install this log set as a vent-free appliance. If not permitted, you may install and operate this log set as a vented appliance.

Important: For safe operation and proper performance of this product and to comply with certification, listings, and building code acceptances, use **ONLY** Peterson Real-Fyre® controls, parts, and accessories that have been specifically listed or certified for use with this burner system. Use of other controls, parts, or accessories is prohibited and will void all warranties, certifications, listings, and building code approvals, and may cause property damage, personal injury, and loss of life.

PRE-INSTALLATION AND FIREPLACE PREPARATION SAFETY

CAUTION: Installation and repair must be done by a qualified professional installer.

Installer: Carefully read these instructions before installing this gas burner system. Be sure you understand all safety precautions and warnings contained in this manual.

- A. This appliance is only for use with the type of gas indicated on the rating plate. This appliance is **NOT CONVERTIBLE** for use with other gasses.
- B. **CAUTION: If not installed, serviced, and used correctly per these instructions, this product can cause serious personal injury, property damage, or loss of life.**

PRE-INSTALLATION AND FIREPLACE PREPARATION SAFETY GUIDELINES

- C. **WARNING:** Before installing in a solid-fuel-burning fireplace, the chimney flue, damper, and firebox must be thoroughly CLEANED of soot, creosote, ashes, and loose paint by a qualified chimney cleaner. Some fireplaces (especially older ones) may need repair prior to installing this appliance.
- D. **CHECK GAS TYPE** (natural or propane): The gas supply must be the same as stated on your burner system rating plate. If gas supply is different, **DO NOT INSTALL**. Contact your dealer for immediate assistance.
- E. Any outside air ducts and/or ash dumps located on the floor or walls of the fireplace must be permanently sealed shut before the installation. Use a heat-resistant sealant. Do not seal the chimney flue damper.
- F. **INSUFFICIENT GAS PRESSURE WILL KEEP THE ODS (OXYGEN DEPLETION SENSOR) PILOT FROM OPERATING PROPERLY. DO NOT USE IF GAS PRESSURE IS LOWER THAN THE MINIMUM REQUIREMENT.**
- G. The *minimum* inlet gas-supply pressure for purposes of input adjustment is **5"** water column (w.c.) on **natural gas** and **11"** w.c. on **propane gas**. Insufficient gas pressure will affect proper operation of the ODS pilot. Do not install this gas appliance if minimum pressure is not available. The *maximum* inlet gas-supply pressure is **10.5"** w.c. on natural gas and **13"** w.c. on propane gas. The propane source must be regulated. (Do not connect this appliance directly to an unregulated propane gas tank - this can cause an explosion.)
- H. The gas piping system must be sized to provide minimum inlet pressure at the maximum flow rate (BTU/hr). Undue pressure loss will occur if the pipe is too small, or the run is too long.
- I. The minimum clearance from the fireplace opening to combustible materials on side walls and ceiling must be maintained as outlined in MINIMUM CLEARANCE TO COMBUSTIBLES - WALLS AND CEILING.
- J. At least 10"-12" of noncombustible or heat-resistant material is required above the fireplace. A fireplace hood will be required to act as a heat deflector in protecting combustible fireplace surrounds (facing and/or mantel) if certain minimum clearances cannot be met.
- K. Be certain that combustible flooring material (i.e., carpet, tile, etc.) is not too close to this gas appliance. If this appliance is at floor level or less than 6" above the floor, there must be at least 12" of noncombustible material between the base of the fireplace and any combustible flooring.
- L. Input ratings shown in BTU per hour are for elevations up to 2,000 ft. For elevations above 2,000 ft., refer to the National Fuel Gas Code or contact the Robert H. Peterson Company before installing this product.
- M. This gas appliance and its main gas valve must be disconnected from the gas-supply piping system during any pressure testing of that system at test pressures in excess of 1/2 psig.
- N. This gas appliance must be isolated from the gas-supply piping system by closing the equipment shutoff valve connected to the gas-supply line during any pressure testing of the gas-supply piping system at test pressures equal to or less than 1/2 psig.
- O. Do not use this appliance if any part has been underwater. Immediately call a qualified service technician to inspect the appliance and to replace any part of the control system and any gas control that has been underwater.

WARNING

THIS APPLIANCE IS EQUIPPED FOR (NATURAL OR PROPANE) GAS.
FIELD CONVERSION IS NOT PERMITTED.

ANSI Z21.11.2-2007 UNVENTED ROOM HEATER GENERAL SAFETY INFORMATION

A. **WARNING: CARBON MONOXIDE POISONING MAY LEAD TO DEATH.**

When used without fresh air, gas appliances may give off carbon monoxide, an odorless, colorless, poisonous gas. Early signs of carbon monoxide poisoning are similar to the flu, with headaches, dizziness, and/or nausea. If you have these signs, the gas appliance may not be installed correctly, or may not be working properly. **GET FRESH AIR AT ONCE! STOP USING THE APPLIANCE IMMEDIATELY!** Have the appliance serviced before use continues. Some people, including pregnant women; persons with heart or lung disease, asthma, or anemia; those under the influence of alcohol; and persons at high altitudes, are more affected by carbon monoxide than others.

If there are **ANY** signs of carbon monoxide, **GET FRESH AIR AT ONCE! STOP USING THIS APPLIANCE IMMEDIATELY!**

- B. If any soot appears on the appliance or other areas of the fireplace in which this appliance is installed, shut system off and call a qualified professional service technician, **vent-free gas log technician**, or your local gas company.
- C. WHEN INSTALLING AS A DECORATIVE VENTED APPLIANCE, THE UNIT MUST CONFORM TO ALL LOCAL CODES AND TO THE LATEST EDITION OF THE NATIONAL FUEL GAS CODE ANSI Z223.1/NFPA54.
- D. This appliance may be installed in an aftermarket, permanently located, manufactured (mobile) home where not prohibited by local codes. Installation of appliances designed for manufactured homes or mobile homes must conform with the *Manufactured Home Construction and Safety Standard, Title 24 CFR, Part 3280* in the U.S.; or with *CAN/CSA Z240 MH, Mobile Housing* in Canada; or with *ANSI/NCSBCS A225.1/NFPA 501A, Manufactured Home Installations Standard* when none of the previously referenced standard are applicable.
- E. Eliminate drafts **before** using the gas appliance by closing heating and air conditioning vents, returns, and outside air vents. Fans blowing directly into the fireplace must be turned off when this appliance is operating.
- F. **WARNING:** This appliance is for installation only in a solid-fuel-burning masonry or UL 127 factory-built fireplace or in a listed ventless firebox enclosure. It has been design certified for these installations. Exception: DO NOT install this appliance in a factory-built fireplace that includes instructions stating it has not been tested or should not be used with unvented gas logs.
- G. State and local codes may only allow operation of this appliance in a vented configuration. Check your state or local codes.
- H. **DO NOT MODIFY THIS VENT-FREE HEATER OR ITS CONTROLS. Any change may be dangerous.** Improper installation or use of your vent-free gas appliance can cause serious injury or death from fire, burns, explosions, or carbon monoxide poisoning.

INSTALLATION SAFETY GUIDELINES

- A. Carefully inspect the burner and log cartons for shipping damage. If any parts are missing/damaged, call your dealer. **Do not attempt** to install the appliance unless all parts are in good condition.
- B. Correct installation of the glass or the ceramic refractory log set and proper placement and installation of burner assembly, including ember placement and Lava Granule placement, are crucial to safe operation of your set. Problems **WILL** occur if all items are not properly installed. Reference INSTALLATION section, LOG PLACEMENT.
- C. When installing in a wood-burning fireplace, **place the appliance forward in the fireplace** while making certain that no part of the assembly protrudes (forward) beyond the face of the fireplace. **DO NOT PUSH THE UNIT ALL THE WAY TO THE BACK.**
- D. If you use Lava Granules for decorative use, do not allow Lava Granules into or on any part of the burner or on the logs. Lava Granules should only be placed on the floor of the fireplace, in front of and to the sides of the burner, but away from the controls.
- E. DO NOT PLACE logs or other accessories, such as wood chips, pine cones, or vermiculite, on this appliance. These items will cause improper burning, sooting, and/or high levels of carbon monoxide. Additional logs and/or accessories may be placed around the burner system, as long as they do not interfere with the burning of your gas appliance.
- F. **Due to high temperatures, this appliance should be located out of traffic and away from furniture/draperies.**
- G. A fireplace screen must be in place when this gas appliance is in operation. Unless other provisions for combustion air are provided, the screen shall have an opening(s) for introduction of combustion air.
- H. Connecting directly to an unregulated propane tank can cause an explosion.
- I. Special care is required if you are installing the unit into a sunken fireplace. You must raise the fireplace floor to allow access to gas log controls. This will ensure adequate airflow and guard against sooting. Raise the fireplace floor using noncombustible materials.
- J. A vent-free room heater having an input rating of more than 10,000 BTU per hour shall not be installed in a bedroom (ANSI Z21.11.2). If local codes allow, you may install a G8-xxR burner, having a rating of 9,500 BTU, in a bedroom. An unvented room heater having an input rating of more than 6,000 BTU per hour shall not be installed in a bathroom (ANSI Z21.11.2).

OPERATIONAL SAFETY INFORMATION

OPERATING YOUR UNVENTED GAS APPLIANCE SAFELY AND CORRECTLY

- A. SOLID FUEL MUST NOT BE BURNED** in a fireplace where this vent-free gas appliance is installed.
- B. GLASS DOORS MUST BE FULLY OPEN** when this vent-free gas appliance is operating. This appliance **MUST NOT BE ON** if glass doors are closed, as it can lead to sooting, burner outages, and possibly explosion, causing damage or injury.
- C. WARNING: DO NOT ALLOW DRAFTS INTO OR AROUND THE FIREPLACE. CLOSE (SHUT) HEATING AND AIR CONDITIONING VENTS, RETURNS, AND OUTSIDE AIR VENTS. DO NOT OPERATE FANS (WINDOW FANS, CEILING FANS, FLOOR FANS), WHICH MAY ALTER FLAME PATTERNS.** Sooting, excess carbon monoxide, or ODS pilot outages may occur due to drafts.
- D. WARNING: DO NOT USE A BLOWER INSERT, HEAT EXCHANGER INSERT,** or any other accessory that is not specifically certified for use with this vent-free gas appliance.
- E.** Make sure there is adequate combustion and ventilation air when this gas appliance is operating. You may need to crack the damper or open a window slightly.
- F.** To light this appliance, it may be necessary to purge the unit for longer than one minute after long periods of non-use.
- G.** If you operate this vent-free gas appliance fueled by propane, operating characteristics may vary as the fuel in the tank approaches empty (less than $\frac{1}{4}$ full). Sooting and other increases in combustion by-products will occur. Turn off the appliance, refill the propane tank, and have the burners cleaned.
- H.** During manufacturing, various parts of this unit are treated with oils or paints. Though not harmful, they may produce annoying smoke and smells as they are burned off during initial operation. This is a normal occurrence. Initial break-in period should last four to six hours; maximum ventilation should be provided by opening windows, doors, or chimney flue.
- I.** Keep the area around your gas appliance clear of combustible materials, gasoline, and any other flammable vapors/liquids. Provide adequate clearance for servicing and operation. Be especially cautious if this gas appliance is installed in a basement or converted garage.
- J. Do not place clothing or any flammable material on or near your vent-free gas appliance. Matches, paper, garbage, or any other material must not be thrown on top of the logs, burner, or into the flame.**
- K.** Young children should be carefully supervised when in the same room with this appliance.
- L.** Children and adults should be alerted to the hazard of high surface temperatures and should stay away to avoid burns or clothing ignition.

OPERATING YOUR UNVENTED GAS APPLIANCE SAFELY AND CORRECTLY

- M. This appliance is intended for supplemental heating, and is not to be used as a primary heating source.** Water vapor produced by vent-free gas logs can create moisture problems in a home when operated for extended periods of time. If condensation begins to occur, open your damper or a window.

As a supplemental zone heater, this set should not be used more than six continuous hours per day or more than 40 hours per week. More frequent use indicates that this unit is being used as a primary heat source. The higher presence of carbon monoxide generated by this amount of use can be considered unsafe.

- N.** If the gas quality is poor or pressure low, your ODS pilot may not stay lit, the burners may produce soot, or the unit may backfire. Contact your local gas supplier immediately.
- O.** This appliance is designed for adults to be present while in operation. Do not leave this unit burning when unattended or while sleeping. **This is an attended appliance.**
- P. WARNING: Failure to keep the primary air opening(s) of the burner(s) clean may result in sooting and property damage.**
- Q. WARNING: All previously applied loose material, such as embers, must be removed prior to reapplication. All replacement loose material must be purchased from the original appliance manufacturer.**
- R.** Unusually tight construction is defined as:
- a)** Walls and ceilings exposed to the outside atmosphere have a continuous water vapor retarder with a rating of 1 perm (6×10^{-11} kg per pa-sec- m^2) or less with openings that are sealed or use gaskets;
 - b)** Weather stripping has been added on openable windows and doors; **AND**
 - c)** Caulking or sealants are applied to areas such as joints around window and door frames; between sole plates and floors; between wall-ceiling joints; between wall panels; at penetrations for plumbing, electrical, and gas lines; and at other openings.

VENTILATION AND CONFINED SPACE SAFETY INFORMATION

IT MAY BE NECESSARY TO OPEN A WINDOW SLIGHTLY (1" - 2") OR OTHERWISE INCREASE VENTILATION. Conditions requiring this include, but are not limited to:

1. Installation in a confined space.
2. Installation in a tightly constructed home.
3. Installation at high altitudes.
4. Certain medical or physical conditions of the homeowner that may be adversely impacted by combustion products created by burning natural or propane gas.

Your vent-free gas log set SHALL NOT BE INSTALLED IN A CONFINED SPACE or unusually tight construction unless provisions are made for adequate combustion and ventilation air.

The National Fuel Gas Code, ANSI Z223.1/NFPA 54 defines a confined space as a space whose volume is less than 50 cu. ft. per 1,000 BTU per hour (4.8 meters³ per kw) of the aggregate input rating of all appliances installed in that space. Rooms communicating directly with the space in which the appliances are installed, through openings not furnished with doors, are considered a part of the unconfined space.

An unconfined space is a space where volume is at least 50 cu. ft. per 1,000 BTU per hour (4.8 meters³ per kw) of the aggregate input rating of all appliances in that space. Rooms communicating directly with the space in which the appliances are installed, through openings not furnished with doors, are considered a part of the space.

WARNING: Do not install the unvented burner system where the room is considered a confined space (see Fig. 9-1).

To determine if the area where this gas log set is to be installed fits the definition of an unconfined space, multiply the length of the room by the width of the room by the height of the room, then multiply by 20. The result is the maximum BTU allowed.

(Length x Width x Height x 20 = Maximum BTUs allowed)

Example: To install a Peterson Real-Fyre® 24" vent-free gas log set with 39,000 BTU (nat. gas) in a space with no other gas-burning appliances, the space **MUST** be 1,950 cu. ft. or larger (assuming an 8' ceiling, space dimensions must be a minimum of 243.75 sq. ft., i.e.; 16.3' x 15', etc.) (see Fig. 9-1).

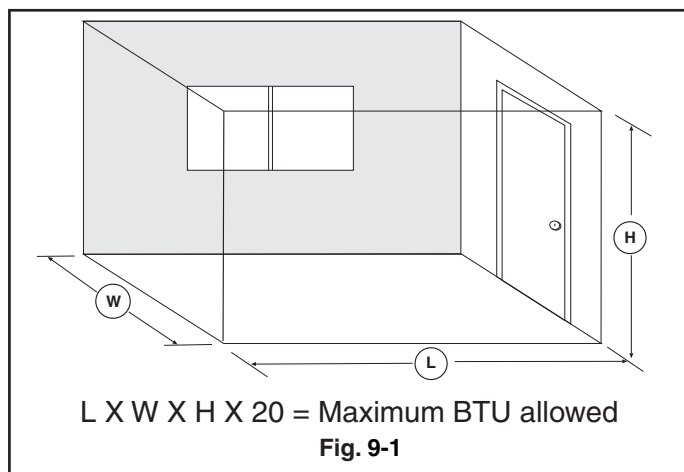

WARNING

If the area in which the heater may be operated is smaller than that defined as an unconfined space or if the building is of unusually tight construction, provide adequate combustion and ventilation air by one of the methods described in the National Fuel Gas Code, ANSI Z223.1/NFPA 54, Air for Combustion and Ventilation, or applicable local codes.

Installation in a tightly constructed home and/or installation at high altitudes may cause your vent-free gas log set to produce excessive heat or excessive moisture. The oxygen depletion sensor may shut down the log set. These conditions may be corrected by opening a window or otherwise increasing the number of air changes in the home.

The Peterson Real-Fyre® vent-free gas log set has been certified to function safely and reliably with emission by-products well within accepted safety and health standards. **Your specific medical or physical condition** may render you more sensitive to products created by burning natural or propane gas. If this is the case, you should open a window or otherwise increase ventilation.

REMEMBER

L X W X H X 20 = MAXIMUM BTUs ALLOWED

If the space is smaller than the above formula allows, and/or smaller than the examples and diagrams on this page specify, **DO NOT** install the vent-free gas log set unless provisions for additional combustion and ventilation air are made.

MINIMUM CLEARANCE TO COMBUSTIBLES

This appliance may only be installed in a listed or masonry fireplace enclosure as indicated in the IMPORTANT SAFETY INFORMATION section. If the unvented gas log set is installed in a factory-built fireplace, follow the manufacturer's guidelines for minimum clearances to combustibles. In the absence of such guidelines, follow the instructions below:

Clearances to Combustible Construction:

Side walls: 6" from side of fireplace opening (Fig. 10-1)
 Ceiling: 42" from top of fireplace opening (Fig. 10-1)
 Mantel: (see Figs. 10-2, 10-3, and paragraph A below)
 Flooring: (see **IN FRONT OF THE FIREPLACE** below)

Note: Clearances to combustible construction are those distances required to ensure that fireplace mantels, facings, walls, ceilings, and floorings will not catch fire.

In most cases, these clearances should also be adequate to prevent any discoloration or warping due to heat. However, every gas log installation presents a different and unique set of circumstances involving many variables beyond the

control of the gas log manufacturer. These include paint or finish composition, previous exposure to heat, methods and quality of construction, airflow patterns, glass doors, fans, or blowers, etc. Because of these variables, we cannot guarantee that heat warping or discoloration will never occur. The potential for heat warping or discoloration may exist no matter what item(s) you are burning in the fireplace, including wood.

The dimensions shown in Fig. 10-1 are **MINIMUM CLEARANCES** to maintain when you install this gas log set. **BOTH SIDES** of the fireplace opening **MUST BE AT LEAST 6"** from any combustible side walls. The ceiling **MUST BE** at least **42"** from the top of the fireplace opening.

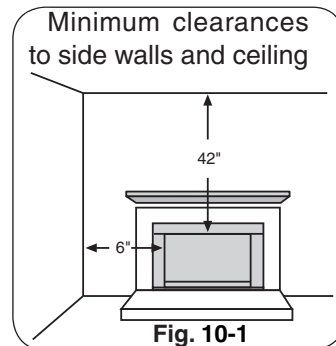

ABOVE THE FIREPLACE:

To install the unvented gas log set, there must **ALWAYS** be noncombustible or heat-resistant material immediately above the fireplace opening. Heat-resistant materials (i.e., marble or slate) must be at least $\frac{5}{8}$ " thick. Sheet metal should not be installed onto combustible materials. If you **DO NOT** install a fireplace hood, there **MUST** be at least **12"** of noncombustible or heat-resistant material immediately above the fireplace opening (see X in Fig. 10-2 below). If you **DO** install a fireplace hood, there **MUST** be at least **10"** of noncombustible or heat-resistant material immediately above the fireplace opening (see Y in Fig. 10-3 below). If there is a wooden mantel, shelf, or other combustible projection above the fireplace, follow the information in Fig. 10-2 or Fig. 10-3 below.

EXAMPLE: If the fireplace has a combustible projection (mantel or shelf) 20" above the top of the firebox, the maximum horizontal projection out from the face of the fireplace will be:

1. If a fireplace hood is not installed - 2.5" (see Fig. 10-2).
2. If a fireplace hood is installed - 10" (see Fig. 10-3).

IF YOU CANNOT MEET THESE MINIMUM CLEARANCES, YOU MUST OPERATE THE UNVENTED GAS LOG SET WITH THE CHIMNEY FLUE DAMPER OPEN.

IN FRONT OF THE FIREPLACE:

Be certain that combustible flooring material (i.e., carpet, tile, etc.) is not too close to the unvented gas log set. If the unvented gas log set is at floor level or less than 6" above the floor, there **MUST** be at least **12"** (1 foot) of noncombustible material between the front of the fireplace and any combustible flooring.

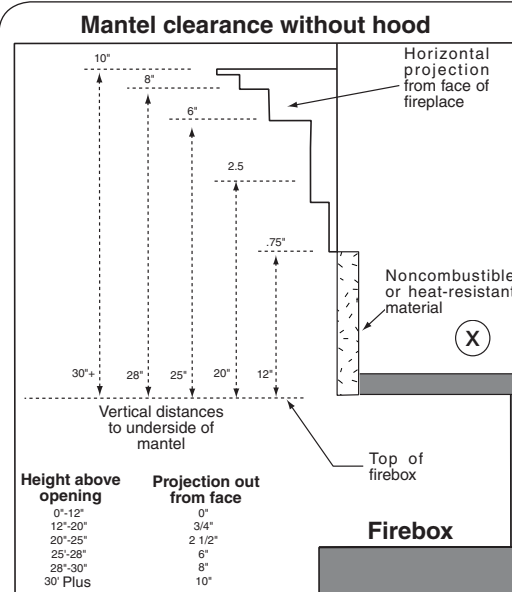

Fig. 10-2

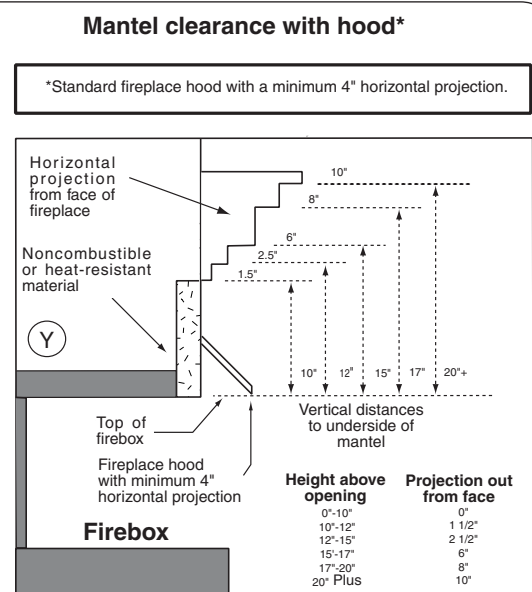

Fig. 10-3

LOGS - PARTS LIST

WARNING: Failure to position these parts in accordance with these diagrams, or failure to use only parts specifically approved with this vent-free gas log set, may result in property damage or personal injury.

(A) CHARRED TRAIL OAK (CHT) UNITIZED CERAMIC FIBER LOG SETS (7 PIECE)

FRONT VIEW



TOP VIEW



BACK VIEW

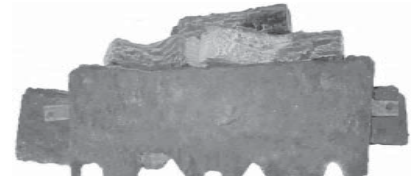

(B) CHARRED TRAIL OAK (CHT) UNITIZED CERAMIC FIBER LOG SETS (9 PIECE)

FRONT VIEW



SIDE VIEW



TOP VIEW

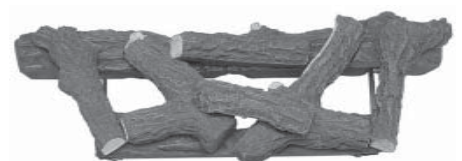

24" & 30" REFRACTORY LOG SETS

CHAS-24 24" CHARRED AGED SPLIT OAK LOG SET

ITEM NO.	PART NO	DESCRIPTION
1.	CHASL-24BF	Charred bottom front log
2.	CHFRL-20BR	Charred bottom rear log
3.	CHFRL-12TL	Top left "Y" log
4.	CHFRL-12TR	Top right "Y" log
5.	CHFRL-7T	Top center log
6.	CHFRL-9T	Top left log
7.	CHFRL-10T	Top right log

[Also available in Charred Summit Oak finish (CHSM-24) and Charred Frontier Oak finish (CHFR-24)]

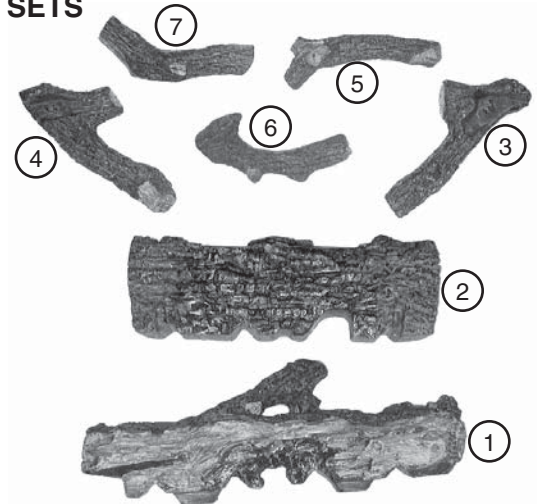

CHFR-30 30" CHARRED FRONTIER OAK LOG SET

ITEM NO.	PART NO	DESCRIPTION
1.	CHFRL-30BF	Charred bottom front log
2.	CHFRL-24BR	Charred bottom rear log
3.	CHFRL-12TL	Top left "Y" log
4.	CHFRL-12TR	Top right "Y" log
5.	CHFRL-7T	Top center log
6.	CHFRL-9T	Top left log
7.	CHFRL-10T	Top right log

[Also available in Charred Aged Split Oak finish (CHAS-30) and Charred Summit Oak finish (CHSM-30)]

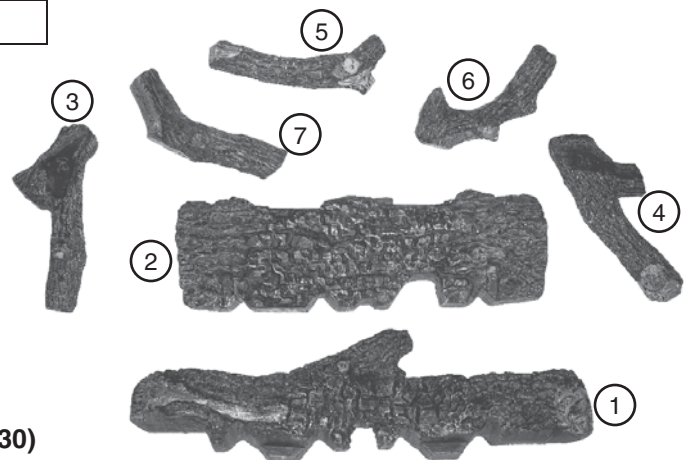

(All photo's not to scale)

Also included with limited gas log sets
Decorative wood chip
[provided with 15(M)(P) and 01V(P)
gas log sets]



Note: For both set sizes, each log is numbered to aid exact placement, giving the correct spacing for proper performance of the gas log set (see installation section for placement details).

BURNER PARTS LIST FOR MANUAL VALVE

G10-24/30(P)

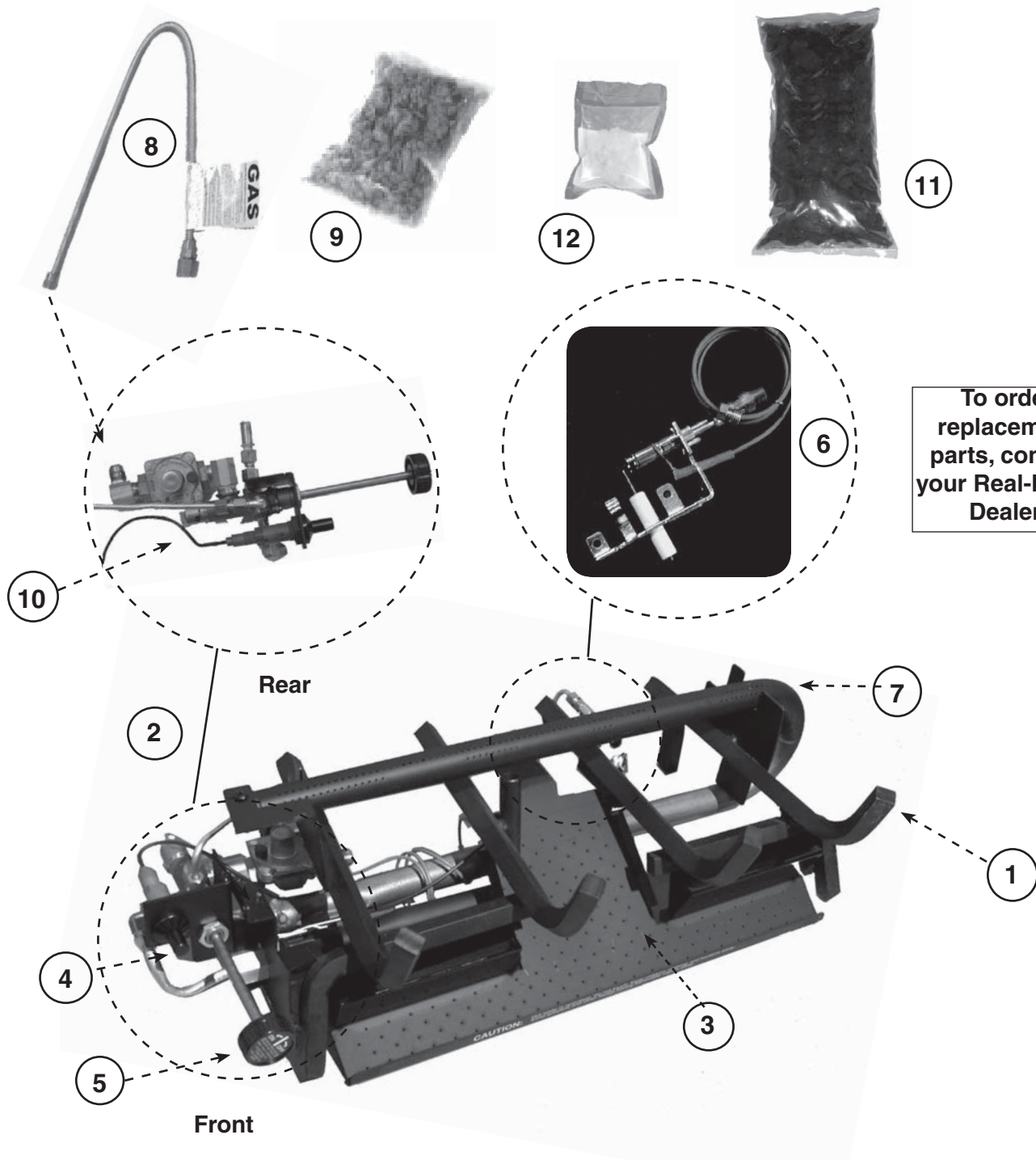

ITEM NO.	DESCRIPTION
1.	Grate assembly
2.	Valve assembly (natural) Valve assembly (propane)
3.	Ember burner
4.	Piezo ignitor
5.	Control knob
6.	ODS pilot (natural) ODS pilot (propane)

ITEM NO.	DESCRIPTION
7.	Main burner
8.	Connector kit, 30"
9.	Embers
10.	Piezo ignitor wire
11.	Lava fyre coals
12.	Bryte coals

BURNER PARTS LIST FOR SERIES 12 VALVE

G10-24/30-12(M)(P)

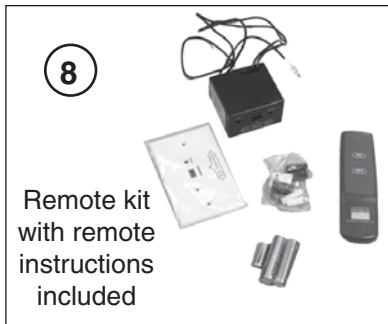

7

13

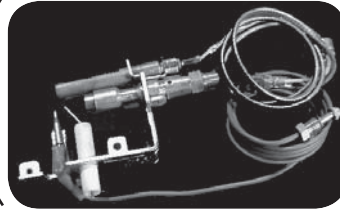
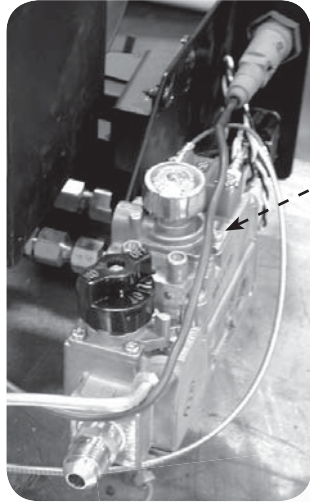

Rear

Front

To order replacement parts, contact your Real-Fyre® Dealer.

ITEM NO. DESCRIPTION

1. Grate assembly
2. Valve assembly (natural)
Valve assembly (propane)
3. Ember burner
4. ODS pilot (natural)
ODS pilot (propane)
5. Main burner
6. Connector kit, 30"

ITEM NO. DESCRIPTION

7. Embers
8. Remote kit (optional)
9. Lava fyre coals
10. ON/ OFF switch
11. Piezo ignitor
12. Piezo wire
13. Bryte coals

BURNER PARTS FOR SERIES 15 VALVE

G10-24/30-15(M)(P)

10

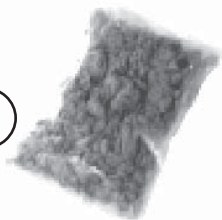

14



12



11

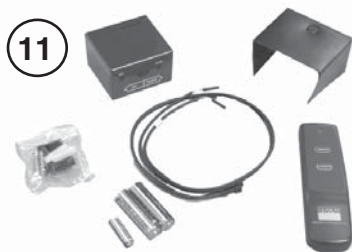

Remote kit with remote instructions included

To order replacement parts, contact your Real-Fyre® Dealer.

Front

Rear

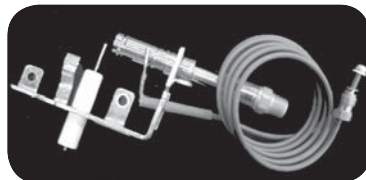
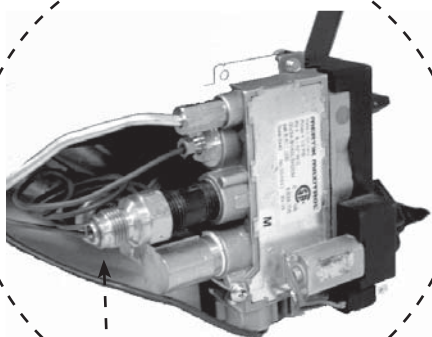

7

8

1



9

2

3

4

5

6

13



ITEM NO. DESCRIPTION

1. Grate assembly
2. Valve assembly (natural)
Valve assembly (propane)
3. Piezo ignitor wire
4. ON/OFF/PILOT ignitor knob
5. Main burner ON/OFF switch
6. Ember burner
7. Main burner

ITEM NO. DESCRIPTION

8. ODS pilot (natural)
ODS pilot (propane)
9. Connector kit, 30"
10. Embers
11. Remote kit (optional)
12. Lava fyre coals
13. Decorative wood chip
14. Bryte coals

BURNER PARTS FOR SERIES 01V VALVE

G10-24/30-01V(P)

To order replacement parts, contact your Real-Fyre® Dealer.

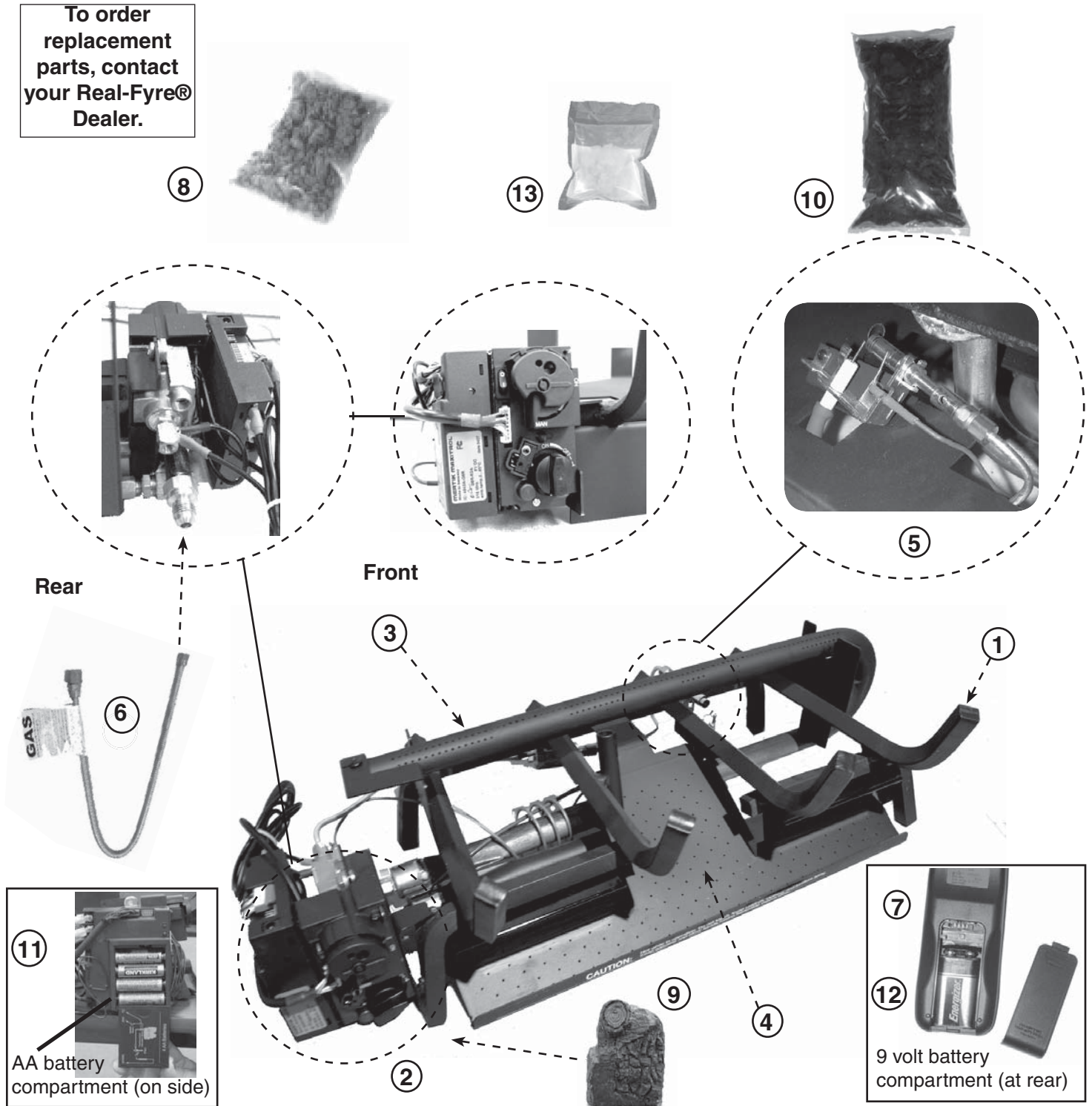

ITEM NO. DESCRIPTION

1. Grate assembly
2. 01V electronic valve assembly with receiver for natural or propane gas
3. Main burner
4. Ember burner
5. ODS pilot (natural)
6. ODS pilot (propane)
7. Gas connector

ITEM NO. DESCRIPTION

7. Remote handset (supplied)
8. Embers
9. Decorative wood chip
10. Lava fyre coals
11. AA batteries (4) - (see inset) above
12. 9 volt battery (1) see inset above
13. Bryte coals

WHEN USED AS A VENTED DECORATIVE APPLIANCE (PER ANSI Z21.60b-2004)

This appliance is for installation in a solid fuel burning fireplace (masonry fireplace or manufactured fireplace) with a working flue and constructed of noncombustible material.

These gas logs may be installed as vented decorative log sets in compliance with ANSI Z21.60b-2004 and National Fuel Gas Code, Section 6.6. The minimum permanent free opening of the fireplace chimney or chimney damper must be at least **29 sq. inches** based upon a minimum chimney height of at least 15'. The chimney damper must be fixed in a manner to maintain permanent free opening at all times. To accomplish this, install a screw or bolt in the edge of the damper to prevent closing, drill holes in the damper, or remove the damper.

INSTALLATION - CONNECTING THE GAS TO THE BURNER SYSTEM

BEFORE PROCEEDING, CAREFULLY READ ALL OF THE IMPORTANT SAFETY INFORMATION CONTAINED IN THIS OWNER'S MANUAL, INCLUDING:

- A. Pre-Installation and Fireplace Preparation Safety Guidelines
- B. Ventilation and Confined Space Information
- C. Installation Safety Guidelines

I M P O R T A N T

Be sure you have read and understand all safety precautions and warnings contained in this manual.

Note: To install the Real-Fyre vent-free gas log set, the fireplace must have a gas supply line that has been installed by a qualified professional technician in accordance with all local codes. Refer to the PARTS LIST when installing the vent-free gas log set.

Tools Required:

- | | |
|---|--|
| 1. Adjustable open-ended wrench | 4. Soapy water solution & brush for leak detection |
| 2. Pliers | 5. Flat-head screwdriver |
| 3. Propane gas resistant pipe compound or Teflon tape | 6. Manometer (recommended for checking gas pressure) |

CHECK GAS TYPE (natural or propane). The gas supply must be the same as stated on the gas log set rating plate. **If the gas supply is different, DO NOT INSTALL.** Contact the dealer for immediate assistance.

W A R N I N G

Do not connect this appliance directly to a high pressure natural gas line or an unregulated propane tank.

Refer to the PARTS LIST when installing the vent-free gas log set.

- 1. MAKE SURE THE FIREPLACE GAS SUPPLY IS TURNED OFF.**
2. Center the burner assembly in the fireplace. Make certain that no part of the assembly protrudes beyond the face of the fireplace.
3. Attach the large adaptor fitting of the flex connector kit to the fireplace gas supply line using pipe compound resistant to propane gas or Teflon tape. Tighten the connection. Connect one end of flex connector to the large adaptor, and the other end to the adaptor on the valve assembly.
4. Make sure that the control valve on the burner system is in the **OFF** position. Turn on the gas to the fireplace and check for leaks at all connections.

LEAK TESTING

Make sure that the control valve on the burner system is in the **OFF** position. Carefully turn on the gas to the fireplace and leak test at all connections by applying a soapy water solution (equal parts liquid detergent and water) to their surface. If bubbles appear, a leak is present. Turn off the gas and tighten all connections, then turn on the gas and repeat the leak test. Repeat until no leaks are detected.

NEVER USE A FLAME TO CHECK FOR GAS LEAKS.

INSTALLATION

IMPORTANT

For all valves, the air **MUST** be purged from the gas line before the ODS pilot will light properly. The time taken to do this will depend on the length of gas line from the meter to the unit, and the length of time since the unit or gas line was last used (in the case of non-use during warm weather for example). It may take from 3-15 minutes before all the air is purged and the ODS pilot will light properly. This is done using different methods, depending on which valve is fitted to the unit. Follow the relevant LIGHTING INSTRUCTIONS in this manual for the specific valve type.

- A. G10(P) - Hold in control knob at PILOT (see Fig. 17-2).
- B. G10-12(M)(P) - Hold down control knob at PILOT (see Fig. 17-3).
- C. G10-15(M)(P) - Hold in control knob at PILOT (see Fig. 17-4).
- D. G10-01V(P) - Set control to manual. Press O/I to I. (see Fig. 17-5) Use a pen tip to activate the switch inside the hole as shown in Fig. 17-1.

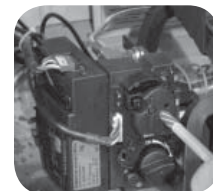

Fig. 17-1

CONTROL SETTINGS

We recommend that before you install the log set you familiarize yourself with the control valve layout. This will help you to be confident operating the log set when fully installed. See the figures below for typical control positions.

MANUAL GAS VALVE OPERATING POSITIONS

OFF PILOT ON/ HIGH ON/ LOW



Fig. 17-2

12 SERIES REMOTE GAS VALVE OPERATING POSITIONS

OFF PILOT ON

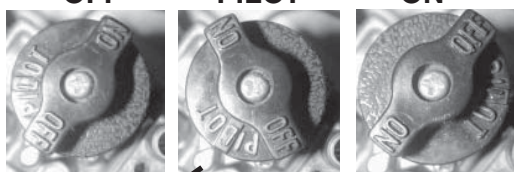

Read setting here

Fig. 17-3

15 SERIES REMOTE GAS VALVE OPERATING POSITIONS

OFF IGNITION PILOT ON

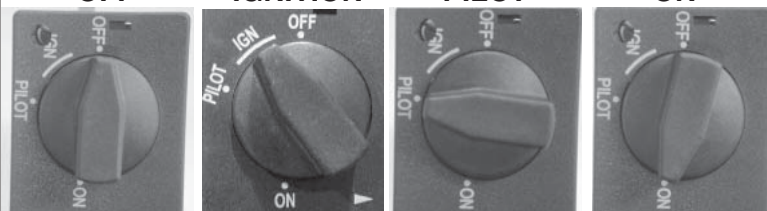
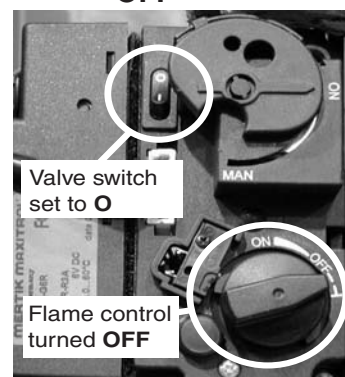

Fig. 17-4

01V SERIES REMOTE GAS VALVE OPERATING POSITIONS

OFF



PILOT ON

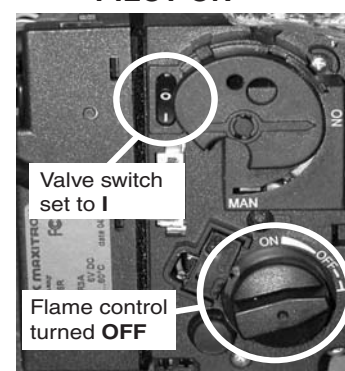

ON

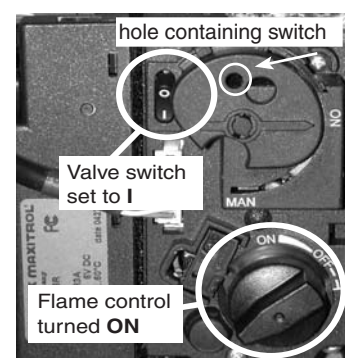

Fig. 17-5

INSTALLATION: CHECKING GAS PRESSURE

IMPORTANT

Check the gas pressure with the vent-free gas log set burning and the control set to **HIGH**.

The gas log set and its main gas valve must be disconnected from the gas supply piping system during any pressure testing of that system at test pressures in excess of $\frac{1}{2}$ psig. (3.5 kPa) The gas log set must be isolated from the gas supply piping system by closing its equipment shut-off valve during any pressure testing of the gas supply piping system at test pressures equal to or less than $\frac{1}{2}$ psig. (3.5 kPa) This is accomplished by closing the gas supply line valve.

CHECKING GAS PRESSURE

Remote ready safety ODS pilot valve (Fig. 18-1)

Check the valve regulator pressure at the pressure *inlet* point. Turn the inlet screw counterclockwise 2 or 3 turns and then place the tubing of the pressure gauge over the pressure *inlet* point. (The test "inlet" point is farthest to the gas supply inlet). After taking the pressure reading, turn the inlet screw clockwise firmly to reseal. Do not over torque. Check for gas leaks.

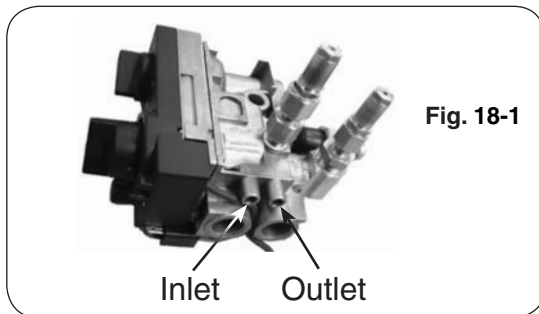

Manual safety ODS pilot valve (Fig. 18-2) The pressure regulator is preset at the factory and locked to discourage tampering. If the pressure is not as specified, replace the regulator with the correct part from the PARTS LIST in this manual. To check the pressure, remove $\frac{1}{8}$ " pressure tap screw plug, located on the side of the regulator body. Install fitting and tubing of pressure gauge. With the unit operating take the pressure reading. Reinstall the pressure tap screw and check for leaks when done.

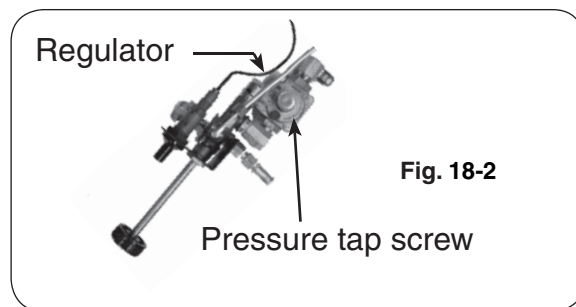

The vent-free burner system will need to be propped up to allow access to the pressure *inlet* and *outlet* points on the bottom side of the valve.

Note: Gas pressure should be checked after connecting the gas and prior to any further installation.

GAS PRESSURE SPECIFICATIONS

NATURAL GAS			
MANUAL PRESSURE		MILLIVOLT PRESSURE	
Regulator pressure reading:	3.5" w.c.	Outlet pressure reading: (Flame adjustment on high)	3.5" w.c.
Gas inlet pressure:	Max. 10.5" w.c. Min. 5" w.c.	Inlet pressure reading	Max. 10.5" w.c. Min. 5" w.c.
PROPANE (L.P.) GAS			
MANUAL PRESSURE		MILLIVOLT PRESSURE	
Regulator pressure reading:	10" w.c.	Outlet pressure reading: (Flame adjustment on high)	10" w.c.
Gas inlet pressure:	Max. 13" w.c. Min. 11" w.c.	Inlet pressure reading	Max. 13" w.c. Min. 11" w.c.

INSTALLATION: GRANULE, EMBER AND LOG PLACEMENT

LAVA GRANULE PLACEMENT

Lava granules are provided as an aesthetic enhancement to the G10 vent-free gas log set. Spread the lava granules on the floor of the firebox around the front and the sides of the vent-free gas log set (Fig. 19-1).

BE SURE THAT NO GRANULES ENTER THE MAIN BURNER OR INTERFERE WITH THE BURNING OF THE LOG SET.

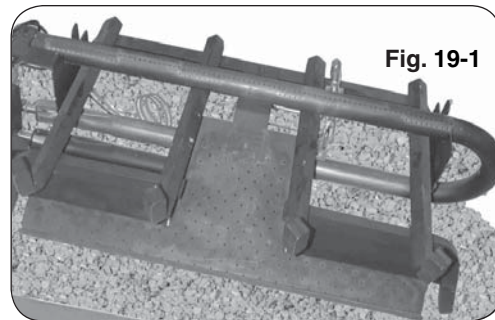

Fig. 19-1

EMBER PLACEMENT

GLOWING EMBER PLACEMENT

The glowing embers are supplied in the larger of the two ember bags containing the darker embers (Fig. 19-2). It is important that only the embers supplied be used and that no additional glowing embers be added. **Open the bag and spread the embers loosely along the entire length of the ember burner (Fig. 19-3) from left to right on the burner and on the vertical portion of the ember burner. Break up any clumps that may have developed during shipment and make sure the embers are spread evenly over the entire area.**

Fig. 19-2



PLATINUM EMBERS (BRYTE COALS) PLACEMENT

With the glowing embers spread evenly across the entire length of the ember burner, open the bag of bryte coals containing a smaller amount of the lighter colored embers (Fig. 19-4) and pinch off (Fig. 19-5) six (6) one inch (1") pieces of the bryte coals. Place the six (6) pieces on top of the glowing embers in the spots shown in Fig. 19-6.

IMPORTANT: DO NOT ADD ANY ADDITIONAL EMBERS TO THIS LOG SET. ANY ADDITIONAL EMBERS MAY CAUSE UNSAFE OPERATION.

Fig. 19-4



Fig. 19-5



Fig. 19-3

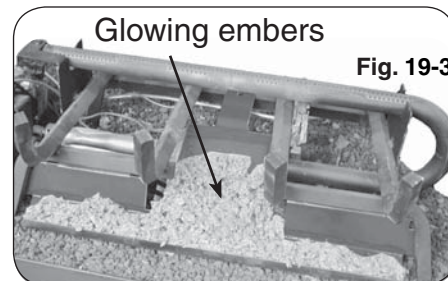
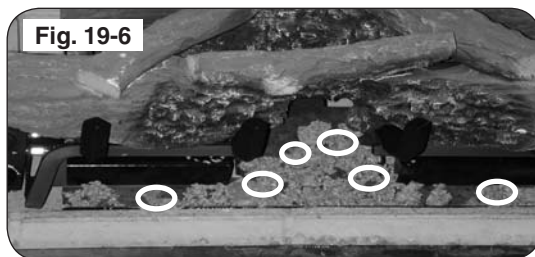

Fig. 19-6



LOG PLACEMENT

WARNING: Failure to position the parts in accordance with these diagrams, or failure to use only parts specifically approved with this heater, may result in property damage or personal injury.

Fiber logs

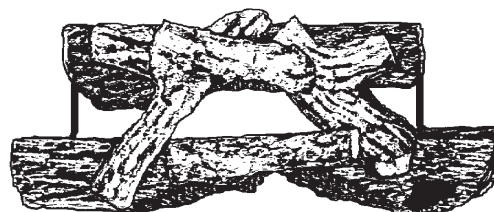

Carefully follow the detailed instructions on the following pages for correct log placement.

INSTALLATION: LOG PLACEMENT

FIBER LOG PLACEMENT

THE CERAMIC FIBER LOG SET IS FRAGILE! TAKE CARE WHEN HANDLING IT TO AVOID BREAKAGE. ONLY LIFT LOG SET USING THE LOG SET BRACKETS

The unitized ceramic fiber log set has been designed with notches on the bottom front and rear logs ensuring positive placement and restricting any movement from side to side. The log support/main burner brackets restrict any forward or backward movement. Make sure the log set is placed in its proper position and that there is no flame impingement on the log set.

1. Place the log set on the grate assembly of the G10 vent-free burner system with the front charred log facing forward.
2. The log set should be positioned with the grate fingers resting in the notches on the bottom of the front and rear logs (Figs. 20-1 and 20-2).
3. The main burner brackets will be positioned between the front and rear logs, restricting forward and backward movement (Figs. 20-2).

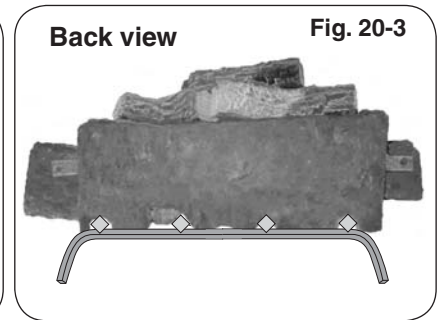
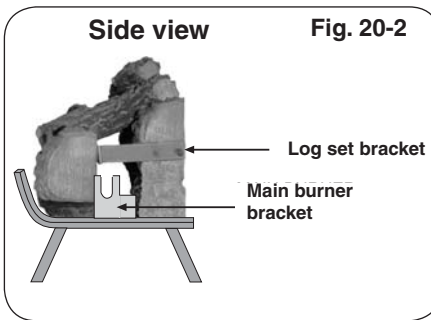
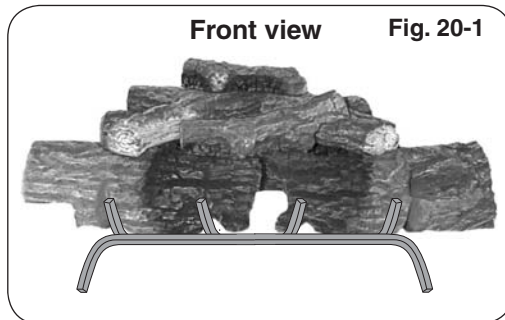

Maintain log position as shown AT ALL TIMES.

REFRACTORY LOG PLACEMENT

Log placement is critical to ensure stability of the logs and proper performance of the gas log set. Be sure to follow log placement instructions carefully!

1. Each log in the Real-Fyre vent-free gas log set is numbered to aid in the log placement procedures. Place the **FRONT** log #1 on the grate and slide it back so the back of the **FRONT** log fits tight up to the front of the main burner bracket on the grate (see Fig. 20-4, Step A). Set the **REAR** log #2 on the grate. Slide it forward so that the rear of the main burner bracket fits into the 2 locating grooves in the **front face** of the log (see Fig. 20-4, Step. B). Check that the logs are centered left to right (see Fig. 20-5).
2. Position the intermediate (Y shaped) logs #3 and #4 on top of the bottom logs. Locate the logs so that each log rests in the corresponding slots on the bottom front log and bottom rear log (see Fig. 20-6).

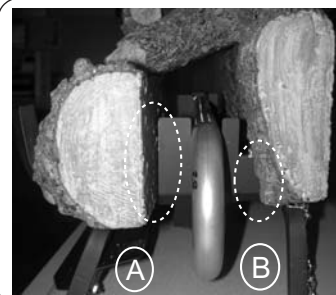
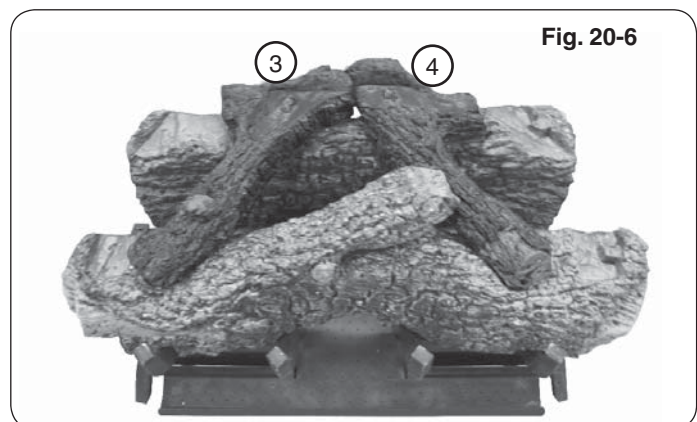
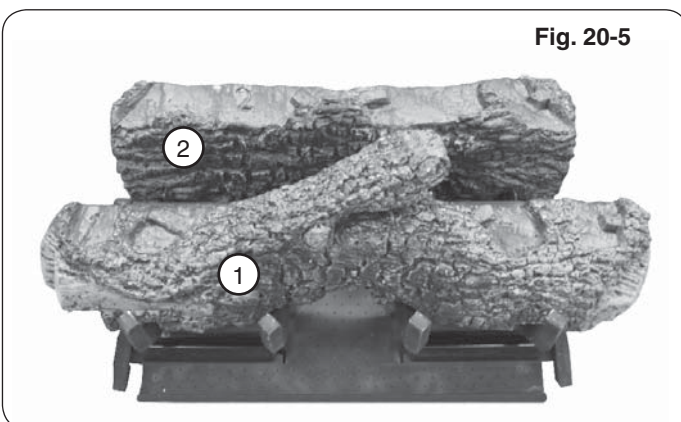

Fig. 20-4

(A)
Ensure back of **FRONT** log is snug up to bracket

(B)
Ensure notches in face of **REAR** log slide over rear of bracket



CHFR-24 log set shown

INSTALLATION: LOG PLACEMENT (Cont.)

REFRACTORY LOG PLACEMENT (cont.)

3. Position the top center log #5 on the top of the intermediate logs. Locate the top log by placing it into the slots of the intermediate logs (see Fig. 21-1).

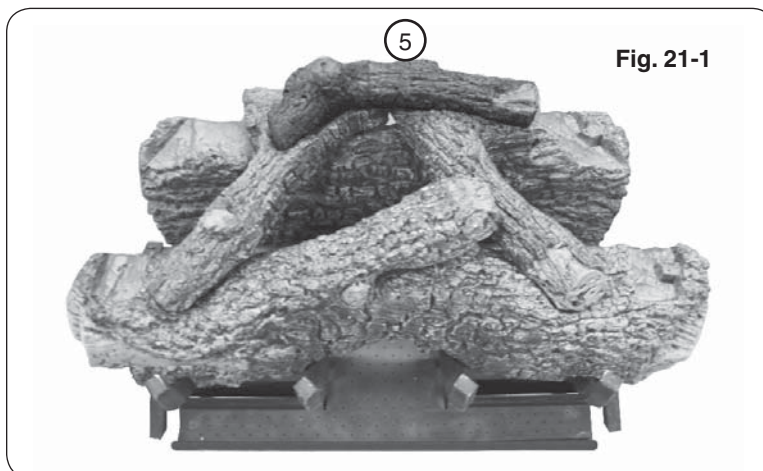

4. Complete the log placement by positioning the top left log #6 and top right log #7 on the bottom logs, being sure to locate them in the corresponding slots (see Fig. 21-2).



After setting the logs into position, as described above, ensure each is properly and firmly seated. The vent-free gas log set will not function as intended if the logs are not correctly positioned. When placed properly, the flames will not strike any portion of logs 3, 4, 5, 6 or 7. Periodically check the positioning of all logs to ensure proper log placement and stability. If any flame is striking any of the logs, recheck log placement. Adjust to conform with instructions. **There should be no flame impingement on these logs.**

CAUTION: BURN HAZARD. LOGS WILL REMAIN HOT FOR SOME TIME AFTER USE.

YOU MUST MAINTAIN THE LOG LAYOUT AS SHOWN TO ENSURE PROPER OPERATION OF THE LOG SET. IF YOU NEED TO REPOSITION ANY LOG TO MAINTAIN THE PROPER LAYOUT, USE HEAT RESISTANT GLOVES OR ALLOW LOGS ADEQUATE TIME TO COOL BEFORE HANDLING.

WOOD CHIP PLACEMENT [15(M)(P) & 01V(P)]

The designer wood chip provided with the 15(P) and 01V(P) log sets is for aesthetics only and does not affect operation of the G10 Series vent-free gas log set. The wood chip should be placed in front of the valve, with at least a 1/2 inch between it and the valve (see Fig. 21-3, and Fig. 22-3).

Note: The wood chip may be **HOT** during and directly after operation of the gas log set. Do not place the wood chip on or in the log set.



CLEANING AND SERVICING SAFETY INFORMATION

CAUTION: Burning embers may cause skin irritation, place and adjust using gloves or an appropriate tool to avoid direct skin contact.

CLEANING AND SERVICING

- A. Always shut off the gas to the vent-free gas log set while performing service work.
- B. Allow the vent-free gas log set to cool before servicing.
- C. **Installation and repair must be done by an NFI Certified or other qualified service person. This unit must be inspected and cleaned annually by a professional service person. It must be checked for clean burning operation and proper ODS appearance, with the correct tools to service this unit. More frequent cleaning may be required.** Excessive lint can build up on this unit from carpeting, bedding material, pet hairs, or other particles in the air. It is critical that all control components, burners, and circulating air passageways be kept clean and free of all obstructions. The ODS pilot is especially sensitive to a dirty environment, and will not function properly if dirty. Make certain all air openings are clean and free of obstructions, including:

1. The two (2) air intake openings on the ODS pilot assembly.
2. The ODS pilot opening.
3. The air shutters on both the front/bottom ember burner and the rear/ top main burner.

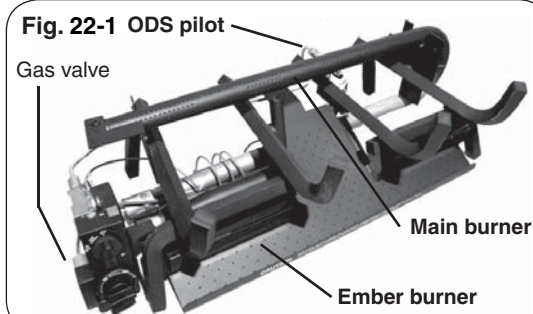

WARNING: Failure to keep the primary air openings of the burner(s) clean may result in sooting and property damage.

4. All of the portholes on both the front/bottom ember burner and the rear/ top main burner (see the section in this manual on CLEANING AND SERVICING).
- D. **Any safety screen or guard removed for servicing must be replaced prior to operating this gas log set.**
 - E. Decorative wood chip (if included) must be placed at least a 1/2 inch away from burner controls to avoid damaging the controls by overheating due to heat reflection (see Fig. 22-3).
 - F. Both ends of the flash tube must remain unobstructed, especially the lower end where embers must be kept away as shown in Fig. 22-4.

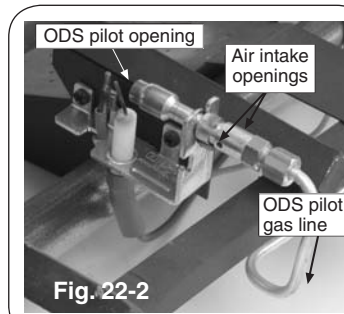

Obstructions in or around the flash tube may result in the ember burner not lighting and/or an intermittent popping noise from the flash tube.

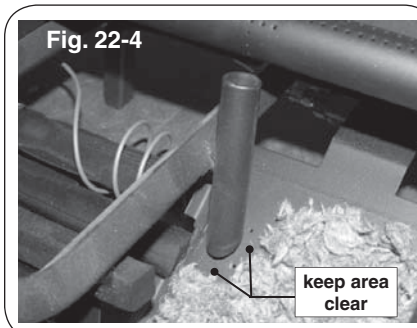
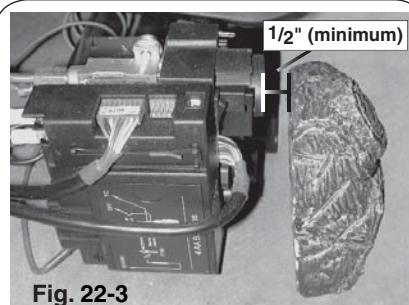

CLEANING AND SERVICING

Only limited cleaning will be required under normal use of the vent-free gas log set.

TO CLEAN THE LOG SET

1. Remove the log set. Use a vacuum cleaner to remove loose particles from all surfaces of the log set. Do not use cleaning fluids.
2. Dust the grate, the assembly, and the burners.
3. Replace the log set as instructed in this manual.

If, after a period of use, the flames start to exhibit unusual shapes and behavior, or the burners fail to ignite smoothly, the burner holes may require some cleaning. If this happens, it is preferable to contact the nearest dealer to get the vent-free gas log set serviced.

Do not remove the rating plates or the warning tags. These are an integral safety and identification component of this appliance.

During periods of heavy use, inspect the vent-free gas log set frequently for evidence of sooting. If sooting is present, discontinue use until the source of sooting is corrected.

CLEANING THE ODS PILOT

Periodic cleaning and maintenance of the vent-free gas log set is recommended to ensure that the log set operates properly. Cleaning of the ODS pilot system is an important part of the maintenance program.

This ODS pilot cleaning procedure must be performed by a qualified professional, service technician familiar with the specific characteristics of the log set.

1. Turn the vent-free gas log set to the off position and allow it to cool. Inspect the ODS pilot area (see Fig. 23-1) for any visual contamination or debris (usually lint, hair, spider webs, or small insects). Lightly brush off all external surfaces while vacuuming loosened debris from the ODS pilot opening. **Be careful not to brush any foreign material into the ODS pilot opening.**
2. Clean out both air intake openings (see Fig. 23-2) by lightly brushing around the openings while vacuuming. Note: It is very important that the air intake openings be kept clear of debris. Should the openings become blocked, the ODS pilot system will not operate properly.
3. Light the ODS pilot according to the relevant LIGHTING INSTRUCTIONS page. Periodically verify the ODS pilot flame appears as shown in the lighting instruction diagram.
4. If the ODS pilot flame does not burn as indicated in the instructions, extinguish the ODS pilot by turning the valve to the full **OFF** position. Using a compressed air duster (commonly available at computer, electronic or office supply stores), insert the flexible nozzle through either air intake openings, insuring that the nozzle is pointed toward the ODS pilot opening (see Fig. 23-2). Blow air through both air intake openings to clear out any debris that may be in the system.
5. Relight the ODS pilot and inspect it to be sure it is burning as shown in the instructions. If not, extinguish the ODS pilot and **turn off the gas supply to the gas log set.** Using an adjustable or a 1/4" wrench, disconnect the ODS pilot gas line (see Fig. 23-1) from the valve.
6. Insert the flexible nozzle of the compressed air duster and blow air into the input end of the ODS pilot gas line to remove any blockages. **Do not blow air directly into the ODS pilot opening. Blow air in the direction of the gas flow.**
7. Reinstall the ODS pilot gas line and check for leaks.
8. Light the ODS pilot to make sure it is operating properly (see the relevant LIGHTING INSTRUCTIONS section).
9. If the ODS pilot still does not operate properly, it may need to be replaced with the same model as the one on the vent-free burner.

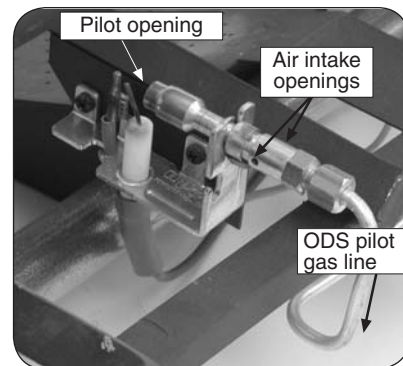

Fig. 23-1

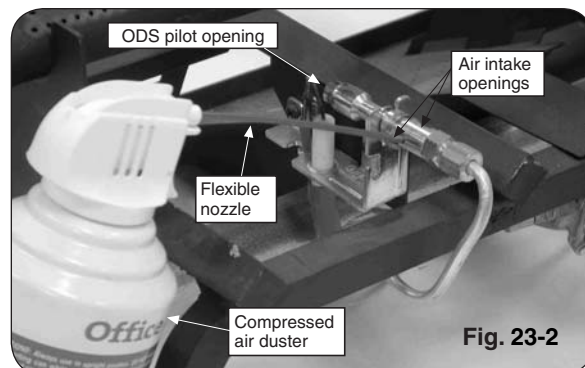

Fig. 23-2

LOG SET NOTES PAGE

Please use this page to record any information about your log set that you may want to have at hand.

LIGHTING INSTRUCTIONS - SERIES 15 VALVE

FOR YOUR SAFETY, READ BEFORE LIGHTING

WARNING

If you do not follow these instructions exactly, a fire or explosion may result, causing property damage, personal injury, or loss of life.

Do not use this appliance if any part has been underwater. Immediately call for a qualified professional service technician to inspect the appliance and to replace any part of the control system and any gas control that has been underwater.

The Real-Fyre® burner system has an ODS pilot. When starting the ODS pilot, follow these instructions exactly.

BEFORE LIGHTING, smell all around the gas burner system area for gas. Be sure to smell next to the floor, as some gas is heavier than air and will settle on the floor. IF YOU SMELL GAS, FOLLOW THE INSTRUCTIONS ON P. 1.

Use only your hand to push in or turn the gas control knob. Never use tools. If the knob will not push in or turn by hand, don't try to repair it. Call a qualified professional service technician. Force or attempted repair may result in fire or explosion.

LIGHTING THE ODS PILOT

1. Turn the ignitor control knob (Fig. 25-1) on the burner control valve assembly to the side of the burner pan counterclockwise ↺ so that the narrowing part of the knob moves from the **OFF** position, slightly toward **IGN**, until reaching the stop.
2. Press the ignitor control knob in and hold in for five seconds (only ODS pilot gas will flow).
3. Continue pressing in while turning the ignitor control knob further counterclockwise ↺ toward the **PILOT** position, until you hear a click. The click is an indication that the piezo ignitor has been activated.

Note: If the spark from the piezo ignitor does not light the ODS pilot, repeat steps 2 & 3 until the ODS pilot lights.

4. Continue to hold the ignitor control knob in the **PILOT** position for 30 seconds after the ODS pilot has been lit to allow the thermocouple to detect the ODS pilot flame.

Note: The ODS pilot flame should always be present when the burner system is in operation, and should just envelop the tip of the thermocouple.

IGNITING THE MAIN BURNER

1. When the ODS pilot flame is stable, release the ignitor control knob and turn counterclockwise ↺ to the **ON** position to enable the main burner.
2. Turn the flame-height control knob (Fig. 25-3) counterclockwise ↺ to the fully **ON** position

(Fig. 25-4) to ignite the burner at maximum BTU. After the main burner ignites, adjust the flame height as indicated below.

ADJUSTING THE FLAME HEIGHT

1. To adjust the flame, turn the flame-height control knob (Fig. 25-3) counterclockwise ↺ to increase the flame height, or clockwise ↻ to decrease the flame height, until the flames have the desired characteristics.
2. When you are finished enjoying your fire, turn the flame-height control knob to **OFF**. The ODS pilot will remain lit. The burner system can be relit by rotating the flame-height control knob toward **ON**.

SHUTTING OFF THE ODS PILOT

If you do not plan on using your burner system for an extended period, you may elect to extinguish the ODS pilot. To do this, rotate the flame-height control knob to the **OFF** position and then rotate the ignitor control knob to the **OFF** position (Fig. 25-1).

Important: When shutting your burner down, be sure to TURN THE FLAME FULLY OFF (to **PILOT** or **OFF**). Make sure the burner is completely off for one minute before relighting.

If this unit was shipped with a remote, or if a remote system was installed later, read and follow the separate remote instructions to operate the burner remotely.

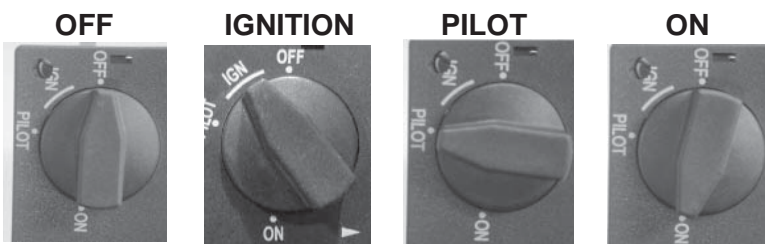

Gas valve operating positions
Fig. 25-1

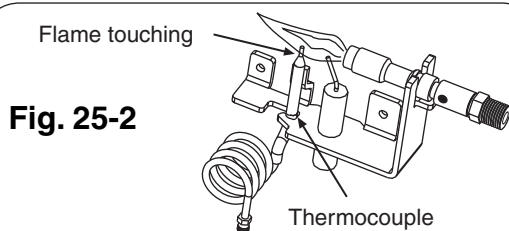

Fig. 25-2

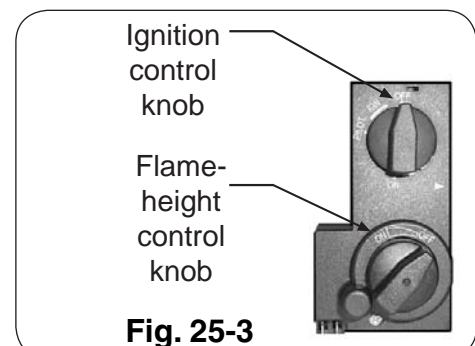

Fig. 25-3



Fig. 25-4

LIGHTING INSTRUCTIONS - SERIES 12 VALVE

FOR YOUR SAFETY, READ BEFORE LIGHTING

WARNING

If you do not follow these instructions exactly, a fire or explosion may result, causing property damage, personal injury, or loss of life.

Do not use this appliance if any part has been underwater. Immediately call for a qualified professional service technician to inspect the appliance and to replace any part of the control system and any gas control that has been underwater.

The Real-Fyre® burner system has an ODS (Oxygen Depletion Sensor) pilot that can be lit by using the built in piezo ignitor switch on the burner, or by hand using a match or long necked lighter. When lighting the ODS pilot, follow these instructions exactly.

BEFORE LIGHTING, smell all around the burner area for gas. Be sure to smell next to the floor as some gas is heavier than air and will settle on the floor. IF YOU SMELL GAS, FOLLOW THE INSTRUCTIONS ON P. 1.

Use only your hand to push in or turn the gas control knob. Never use tools. If the knob will not push in or turn by hand, don't try to repair it. Call a qualified professional service technician. Force or attempted repair may result in fire or explosion.

LIGHTING THE ODS PILOT

To read the safety valve control knob (Fig. 26-1), read the marking nearest the teardrop-shaped metal pointer.

1. If the safety valve control knob is in the **PILOT** position, push in slightly on the knob and rotate it clockwise ↻ to the **OFF** position.
2. Release knob and wait five minutes.
3. Turn safety valve knob counterclockwise ↻ to the **PILOT** position. (Only the ODS pilot gas will flow when the knob is pushed in.)
4. Push and hold the safety valve knob fully in and push in the piezo ignitor button several times until the ODS pilot lights.
5. Hold the safety valve knob in for approximately 60 seconds before releasing.
6. If the ODS pilot does not stay lit, turn the safety valve knob clockwise ↻ to the full **OFF** position. Wait five minutes, then repeat steps 3 through 5.

IGNITING THE MAIN BURNER

With the ODS pilot lit, turn the safety valve knob counterclockwise ↻ to the **ON** position. Switch the toggle switch control to the **ON** position and the burner will light. Refer to the PARTS LIST for the toggle switch location.

SHUTTING OFF THE MAIN BURNER

Switch the toggle switch control clockwise ↻ to the **OFF** position. The ODS pilot will remain lit.

SHUTTING OFF THE ODS PILOT

Be sure the toggle switch control is **OFF** and depress and turn the safety valve knob clockwise ↻ to the **OFF** position.

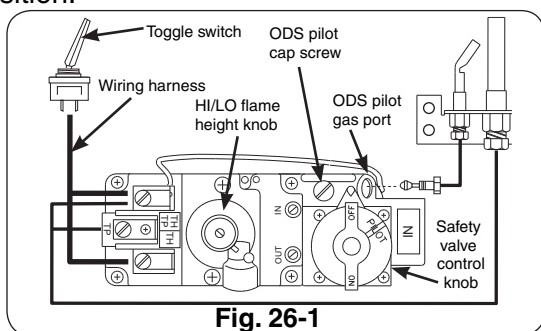

ADJUSTING THE ODS PILOT

- a. The ODS pilot flame should encircle the generator tip, and is preset at the factory (Fig. 26-2). Ordinarily, the ODS pilot will not require field adjustment.
- b. If adjustment is necessary, remove the cap screw (Fig. 26-1) and turn the smaller gas adjustment screw inside counterclockwise ↻ to increase the ODS pilot flame, and clockwise ↻ to decrease the ODS pilot flame. Replace the cap screw.

MAINTENANCE

Your pan burner is equipped with a safety ODS pilot that will shut off the gas supply in case the ODS pilot is not burning or functioning properly. Make sure the ODS pilot is adjusted properly and that the generator spade clips are tightly connected to the terminal screws on the valve. If the ODS pilot will not stay lit, call your local gas utility or gas supplier.

A periodic check of the following should be performed at least annually by a qualified professional service representative:

1. Valves and toggle switch control for proper operation.
2. Flue system for rust, damage, or leaks.
3. Damper operation.
4. Orifices for dirt or other foreign matter.
5. Visual check on the burner.

If this unit was shipped with a remote, or if a remote system was installed later, read and follow the separate remote instructions to operate the burner remotely.

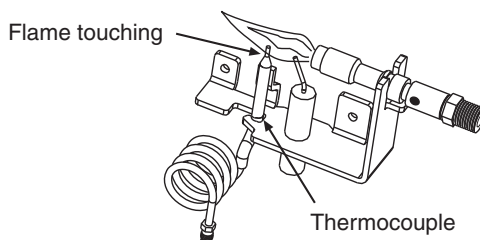

Note: ODS pilot flame should encircle top of the thermopile

LIGHTING INSTRUCTIONS - MANUAL VALVE

FOR YOUR SAFETY, READ BEFORE LIGHTING

WARNING: If you do not follow these instructions exactly, a fire or explosion may result, causing property damage, personal injury, or loss of life.

Do not use this appliance if any part has been underwater. Immediately call for a qualified professional service technician to inspect the appliance and to replace any part of the control system and any gas control that has been underwater.

The Real-Fyre® burner system has an ODS pilot. When starting the ODS pilot, follow these instructions exactly.

BEFORE LIGHTING, smell all around the gas burner system area for gas. Be sure to smell next to the floor as some gas is heavier than air and will settle on the floor. IF YOU SMELL GAS, FOLLOW THE INSTRUCTIONS ON P. 1.

Use only your hand to push in or turn the gas control knob. Never use tools. If the knob will not push in or turn by hand, don't try to repair it. Call a qualified professional service technician. Force or attempted repair may result in fire or explosion.

LIGHTING THE ODS PILOT

1. Push in the gas control knob (Fig. 27-1) slightly and turn clockwise ↻ to **OFF**.

Note: The burner control knob cannot be turned from **PILOT** to **OFF** unless the handle is pushed in slightly. Do not force.

2. Turn the control knob on the gas valve counterclockwise ↺ to **PILOT**.

Note: The burner control knob cannot be turned from **OFF** to **PILOT** unless the handle is pushed in slightly. Do not force.

Wait five minutes to clear out any gas. If you then smell gas, STOP! Notify your gas supplier or the fire department immediately. If you don't smell gas, go on to step 2.

3. Push in on the control knob all the way and hold in. Immediately light the ODS pilot with a long-neck butane lighter or press in ignitor button (Fig. 27-1) to light the ODS pilot. Continue to hold the control knob in for approximately 30 seconds after the ODS pilot is lit. Release the knob, and it will pop back out. The ODS pilot should remain lit. If it goes out, repeat steps 4 through 5.
- If the knob does not pop back out when released, stop and immediately call your service technician or gas supplier.
 - If the ODS pilot will not stay lit after several tries, follow the instructions for SHUTTING OFF THE ODS PILOT and call your service technician or gas supplier.

Manual valve system

Fig. 27-1

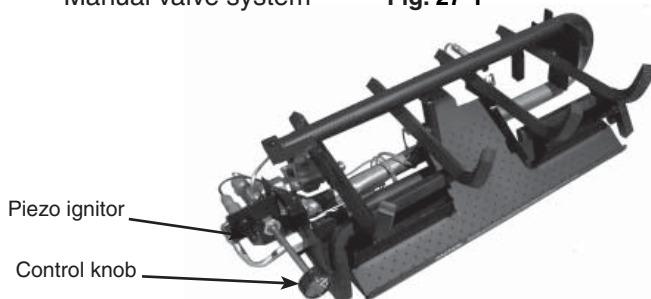

IGNITING THE MAIN BURNER

1. Push in slightly and rotate your manual control knob in a counterclockwise ↺ direction to the **ON/HIGH** position (first stop past **PILOT** position, see Fig. 27-2). The main burner will ignite at maximum BTU.

ADJUSTING THE FLAME HEIGHT

1. To lower the setting, push in slightly and continue to turn in a counterclockwise ↺ direction. When you reach the stop, your burner is at minimum **LOW** position.
2. To turn off *the main burners only*, push in slightly and rotate the manual control knob clockwise to the **PILOT** position. The **ODS pilot flame will remain lit**.

SHUTTING OFF THE ODS PILOT

If you do not intend to use your log set for an extended period of time, you may elect to turn the manual control knob to the **OFF** position. This will extinguish the ODS pilot. The next time you use the set, you will have to light the ODS pilot as described in LIGHTING THE ODS PILOT.

Note: When shutting your log set down, be sure to **TURN THE FLAME COMPLETELY TO THE OFF POSITION**. Make sure the burner is completely off for one minute before relighting!

If this unit was shipped with a remote, or if a remote system was installed later, read and follow the separate remote instructions to operate the burner remotely.

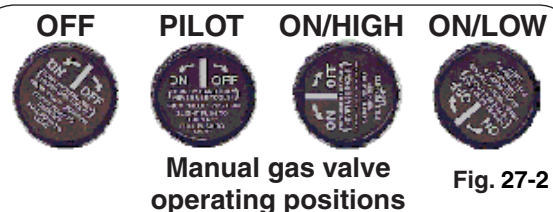

WARNING: NO ADJUSTMENTS ARE TO BE MADE TO THE ODS PILOT SYSTEM. TAMPERING WITH THIS SYSTEM CAN BE EXTREMELY HAZARDOUS.

LIGHTING INSTRUCTIONS - 01V(P) VALVE

FOR YOUR SAFETY, READ BEFORE LIGHTING

WARNING: If you do not follow these instructions exactly, a fire or explosion may result, causing property damage, personal injury, or loss of life.

Do not use this appliance if any part has been underwater. Immediately call for a qualified professional service technician to inspect the appliance and to replace any part of the control system and any gas control that has been underwater.

The Real-Fyre® burner system has an ODS pilot. When starting the ODS pilot, follow these instructions exactly.

BEFORE LIGHTING, smell all around the gas burner system area for gas. Be sure to smell next to the floor, as some gas is heavier than air and will settle on the floor. IF YOU SMELL GAS, FOLLOW THE INSTRUCTIONS ON PAGE 1.

Use only your hand to push in or turn the gas control knob. Never use tools. If the knob will not push in or turn by hand, don't try to repair it. Call a qualified professional service technician. Force or attempted repair may result in fire or explosion.

LIGHTING THE ODS PILOT

1. Locate your electronic control valve (see PARTS LIST, Item 2). Turn the control arrow to **MAN** for manual mode (see Fig. 28-1).
2. Press the ON/OFF switch from **O** to **I** (see Fig. 28-1). Using a small bladed screwdriver or similar, press and hold the button within the hole on the control (see Fig. 28-2). Using a long-neck butane lighter, ignite the ODS pilot flame. Hold in the button for about 1 minute (or longer if first use or after a long period of non-use).
3. The ODS pilot flame should now remain lit. It should always be present when the gas log set is in operation and just envelop the tip of thermocouple. If the ODS pilot light goes out, repeat steps 1-2. If the ODS pilot will not stay lit after several tries, follow the instructions TO TURN OFF GAS TO APPLIANCE in your owner's manual and call your service technician or gas supplier.

IGNITING THE MAIN BURNER

1. When the ODS pilot flame is stable (remains lit, beeping stops), turn the control knob to **ON**. Turn the flame height control knob counterclockwise ↺ past **ON**; gas will flow to the main burner, and the main burner will ignite. The ember burner will ignite shortly afterward.

ADJUSTING THE FLAME HEIGHT

1. To adjust the flame height, turn the flame height control knob (see Fig. 28-3) until the desired flame

height is reached (counterclockwise ↺ to increase, clockwise ↻ to decrease).

2. To turn off *just the main burners*, turn the flame height control knob fully clockwise ↻ until flame is extinguished. **The ODS pilot flame will remain lit.**

SHUTTING OFF THE ODS PILOT

If you do not plan on using your log set for an extended period you may elect to extinguish the ODS pilot. To do this, press the I/O switch on the valve to **O**. This will completely shut down the log set (main burners and ODS pilot will extinguish). This will require that you relight the ODS pilot before you use the log set again. To do so, follow steps 1-2 above. Always turn flame height control knob to the **OFF** position when shutting it down.

Note: When completely shutting your log set down, be sure to TURN THE (I/O) SWITCH ON THE VALVE TO O (OFF). Make sure the burner is completely off for 1 minute before relighting!

To operate the burner using a remote handset and receiver, follow the instructions supplied with the remote.

CHECKING THE ODS PILOT FLAME

1. The ODS pilot flame must be present when the burner is operating. The flame should touch the top of the thermocouple tip (Fig. 28-4).
2. If the ODS pilot flame does not touch the top of the thermocouple tip, then the main burner will not function properly (see Fig. 28-5 for incorrect ODS pilot flame).
3. With the burners off, the ODS pilot flame off, and the assembly cool, check the burner assembly, air intake openings on the ODS pilot, and air shutter openings on the burner for any blockages that could affect the operation of the ODS pilot flame.

ODS PILOT FOR REMOTE VALVES

(NG shown)

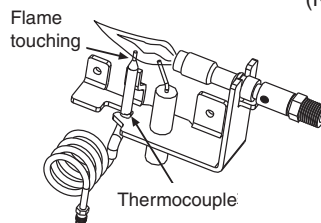

Correct ODS pilot flame

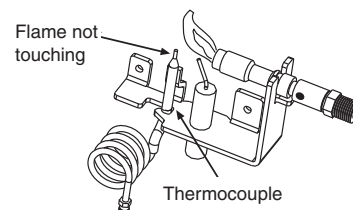

Incorrect ODS pilot flame

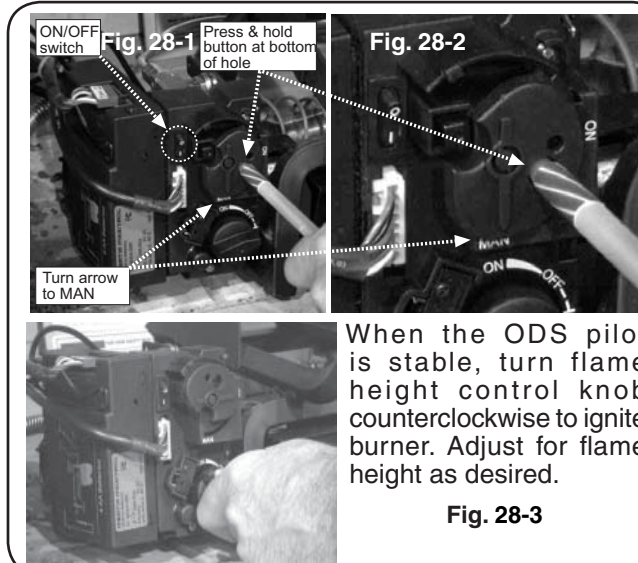

When the ODS pilot is stable, turn flame height control knob counterclockwise to ignite burner. Adjust for flame height as desired.

Fig. 28-3

TROUBLESHOOTING

POSSIBLE CAUSE	SOLUTIONS
<div>1</div> BURNER SHUTTING DOWN DURING OPERATION	
A. Insufficient or excessive gas pressure	A1. Check gas pressure (check with local gas company). For natural gas, pressure must be minimum 5" w.c. at fireplace with burner operating. Maximum inlet gas pressure is 10.5", w.c. Reading at inlet pressure tap (farthest to valve inlet) on remote-capable valves burners should be 5" w.c. (minimum). With the knob on high, maximum inlet pressure is 10.5" w.c. A2. Other gas appliances may be on the same gas line, dropping gas pressure to the log set. Check pressures with everything operating to ensure adequate pressure.
B. Foreign debris in or around the fireplace and around the air intake of the ODS pilot	B. Dust, carpet fibers, paper, spider webs, pet hair, etc. in fireplace or on burner assembly can affect operation of burner and ODS pilot assembly. Clean out debris and vacuum around burner for accumulated dust. Vacuum or use compressed air to clean out the ODS pilot assembly area, air shutter holes, burner orifices, and ODS pilot air intake openings. Blockage in this area will affect the operation of the ODS pilot assembly.
C. Room size (unconfined space)	C. 50 cu. ft. is required for every 1,000 BTU. Multiply the room's length x width x height by 20 (L x W x H x 20). If resulting number is less than the BTU rating of the burner, ODS pilot outages may occur. Provisions for adequate combustion and ventilation air must be made (see VENTILATION AND COMBINED SPACE SAFETY INFORMATION).
D. Log placement	D. Your logs may have notches for correct placement. The burner may have brackets for correct placement. Make sure log set is placed in proper position (see LOG PLACEMENT) so there is no flame impingement on the log set.
E. Flue area, fireplace, or damper dirty from soot	E. Clean around, above, and under damper thoroughly. Clean fireplace, removing loose material, including soot and creosote.
F. Fans, furnaces, air conditioning vents, returns, or fireplace outside air vents near or blowing into fireplace may create drafts, altering flame patterns	F. Eliminate drafts by closing heating and air conditioning vents, returns, and closing outside air vents. Fans blowing directly into the fireplace should be turned off when set is operating.
G. Blockages on burner	G. Vacuum any Lava Granules or material that may have fallen onto burner pipe area
H. Fireplaces with high top cavities can accumulate by-products of combustion, which can start recirculating, causing shutdown	H. Open window or damper slightly. Move burner forward if possible, or otherwise increase ventilation.
I. Insufficient air circulation	I. Check log placement, Glowing Ember placement, Bryte Coals™ placement, and sizing of log set (check your owner's manual for proper placement and requirements). Reposition burner closer to the front of fireplace. (Note: Do not place burner too close to combustibles.) (See INSTALLATION SAFETY GUIDELINES section.)
J. Fireplace too small for unit	J. Ensure minimum requirements are met (see FIREPLACE SIZE REQUIREMENT section).
K. At high altitude, too much heat or moisture can cause ODS pilot to shut down log set	K. Open a window or the damper slightly or otherwise increase the ventilation. Your set may not be certified for use over 2,000 feet. Check your owner's manual.
L. ODS pilot flame lifting off thermocouple/generator	L. Check gas pressure (see item A1 in this table).
M. Soot inside burner	M. Take burner tube out of unit and shake it or tap it to loosen soot inside burner. Clean thoroughly and place burner tube back onto unit.
N. Pilot (remote-capable)	N. Contact your dealer for instructions on replacement.

TROUBLESHOOTING (Cont.)

POSSIBLE CAUSE

SOLUTIONS

2

ODS PILOT WILL NOT LIGHT

A. ODS pilot flame lifting off thermocouple/generator	A. Check gas pressure.
B. Piezo spark not lighting ODS pilot	B. Check to make sure piezo is sparking when turning ignitor control knob. (Note: You may need to turn ignitor several times to ignite ODS pilot.) See LIGHTING INSTRUCTIONS section.
C. Gas supply off/manual shutoff valve closed	C. Turn on gas supply or open manual shutoff valve.
D. Air in gas line	D. Hold control knob to bleed the line and repeat LIGHTING INSTRUCTIONS until air is removed.

3

HIGH CO - CARBON MONOXIDE DETECTORS IN HOME TURNING ALARM ON

A. High CO levels	A. TURN OFF UNIT IMMEDIATELY.
	B. Call a qualified service technician or your gas supplier.

4

CONDENSATION

A. High room humidity and cold walls or windows will create condensation in room	A. Open a window or damper slightly.
--	--------------------------------------

5

LOW FLAME HEIGHT

A. Low gas pressure	A. Check gas pressure.
B. Propane tank running low	B. Fill tank completely.

6

BURNER NOT BURNING EVENLY

A. Top burner lights; bottom burner has delayed ignition or does not light	<p>A1. Check gas pressure. Can be caused by too small a gas line (see ANSI 223.1/NFPA 54 Piping Guidelines).</p> <p>A2. Low propane fuel gas level. Vacuum burner tube for soot blockage and fill propane tank.</p> <p>A3. Flash tube (if present) blocked. Clear blockage.</p>
B. Burner orifice clogged	B. Clean burner orifice.

7

NO SPARK AT ODS PILOT WHEN IGNITOR CONTROL KNOB IS TURNED

A. Ignitor electrode wire loose	A. Check wiring and reconnect any loose wiring
---------------------------------	--

8

ODORS

A. New log set (break-in period)	A. Burn unit for four to six hours with damper, doors, or windows open. Allow odors to dissipate.
B. Odors created by aerosol sprays, detergents, household chemicals, and insecticides	B. When these odors are drawn into the fireplace, this may cause objectionable odors. Thoroughly ventilate the area before restarting your log set.
C. Gas leak	C. Locate gas leak and correct all leaks.
D. New home, new carpet, or new paint	D. When these odors are drawn into the fireplace, this may cause objectionable odors. Thoroughly ventilate the area before restarting your log set.

TROUBLESHOOTING (Cont.)

POSSIBLE CAUSE	SOLUTIONS
9 SOOTING	
A. Low gas pressure	A. Check gas pressure.
B. Drafts in room	B. Eliminate drafts by closing heating and air conditioning vents, returns, and outside air vents. Fans blowing directly into fireplace should be turned off when set is operating.
C. Air shutters blocked	C. Burner air shutters are blocked with debris. Vacuum debris in and around burner area.
D. Log placement	D. Some log sets have notches on the bottom front and rear logs to restrict any side-to-side movement. The log support/main burner brackets restrict any forward or backward movement. Make sure log set is placed in its proper position as instructed in the owner's manual, so there is no flame impingement on log set.
E. Too many embers on the ember burner (where fitted)	E. Remove any additional embers not included with your vent-free gas log set. Important: DO NOT ADD ANY ADDITIONAL EMBERS TO THIS LOG SET. ANY ADDITIONAL EMBERS MAY CAUSE UNSAFE OPERATION.
F. Using a product other than Real-Fyre® gas logs with burner	F. Make sure only Real-Fyre® <u>vent-free</u> gas logs are used with your vent-free burner.
G. Using natural gas burner on propane gas or propane burner on natural gas	G. Make sure burner is set up for the gas you are using. Check nameplate attached to burner. Call your dealer immediately if nameplate does not match the gas you are using.
H. Adding any accessories to log sets	H. Shut down log set and take off any logs or accessories that do not belong with the set.
I. Blocked orifices or air shutters	I. Dust, lint, fibers, paper, spider webs, pet hair, etc. in the fireplace and on the burner assembly can affect the operation of the burner and the ODS pilot assembly. Clean out the debris and vacuum around burner for dust that may have accumulated over time. Vacuum the ODS pilot assembly and over the air shutter holes. Any blockages in this area will affect the operation of the ODS sensor.

10 ODS PILOT WILL NOT STAY LIT WHEN KNOB IS RELEASED	
A. Haven't held knob in long enough	A. Hold knob in for 1 minute and release. If the knob doesn't hold, contact your dealer for service (valve replace or new ODS).

11 POPPING NOISE COMING FROM BURNER	
A. Flash tube blocked	A. Clear flash tube of all obstructions, especially around the bottom.

FLAME DESCRIPTION

Observe the flames. The main burner flames should be blue at the base and a combination of blue/ yellow at the body and at the tips. They should be 5" to 8" above the logs, with the center flame being the tallest (see cover photo). Flames in the ember burner should be 1/4" above the embers.

WARRANTY

PETERSON VENT-FREE GAS LOG SETS LIMITED WARRANTY

All Peterson vent-free ceramic refractory gas logs are **WARRANTED for as long as you own them (lifetime)**.

All Peterson vent-free fiber ceramic gas logs are **WARRANTED for SEVEN (7) YEARS**.

All Peterson vent-free burner component parts, except valves, ODS pilots, and controls, are **WARRANTED for TEN (10) YEARS**.

All Peterson valves, ODS pilots, and controls are covered by a **ONE (1) YEAR Limited Warranty (excluding batteries)**.

PLEASE KEEP A COPY OF YOUR SALES SLIP FOR PROOF OF PURCHASE

This warranty applies to the original purchaser and to single family residential use only. It commences from date of purchase, and is valid only with proof of purchase.

This warranty does not cover parts becoming defective through misuse, accidental damage, electrical damage, improper handling, storage, and/or installation. Product must be installed (and gas must be connected) as specified in the instructions or operator's manual, by a **qualified professional installer**. Accessories, parts, valves, remotes, etc., when used must be Peterson Co. product.

This warranty **does not** apply to rust, corrosion, oxidation, or discoloration, unless the affected component becomes inoperable. It **does not** cover labor or labor-related charges.

This warranty specifically excludes liability for **indirect, incidental**, or consequential damages. Some states do not allow the exclusion or limitation of incidental or consequential damages, so the above exclusion may not apply to you. This warranty gives you specified legal rights, and you may have other rights that may vary from state to state.

For additional information regarding this warranty, or to place a warranty claim, contact the R.H. Peterson dealer where the product was purchased.

WHEN USED IN THE COMMONWEALTH OF MASSACHUSETTS

**INSTALLATION OF THIS APPLIANCE MUST BE PERFORMED BY A
MASSACHUSETTS LICENSED PLUMBER OR GAS FITTER ONLY.**

**THE INSTALLATION OF THIS APPLIANCE MUST CONFORM TO THE BOARD
OF FIRE PREVENTION REGULATIONS 527 CMR 30.00 UNVENTED PROPANE
OR NATURAL GAS-FIRED SPACE HEATERS.**

**This vent-free gas appliance is designed for use in a standard wood-burning
fireplace. It is designed to be used with an external wall switch or external
remote thermostatic control system. Models with the suffix 12(P) or 01(P) are
designed to be used with an external wall switch or an external remote wall
thermostatic control system.**

ROBERT H. PETERSON CO.

Quality Check

Date: _____

Orifice # (Main): _____

Orifice # (Other): _____

Leak Test: _____

Burn Test: _____

Gas Type: NAT. / PROPANE

Model #: _____

Serial #: _____

Air Shutter: _____

Inspector: _____